

RoadVue

ROADVUE RV11

User Guide

This product records videos while the vehicle is operating.
Read and follow the instructions in this guide to properly use and maintain the product.

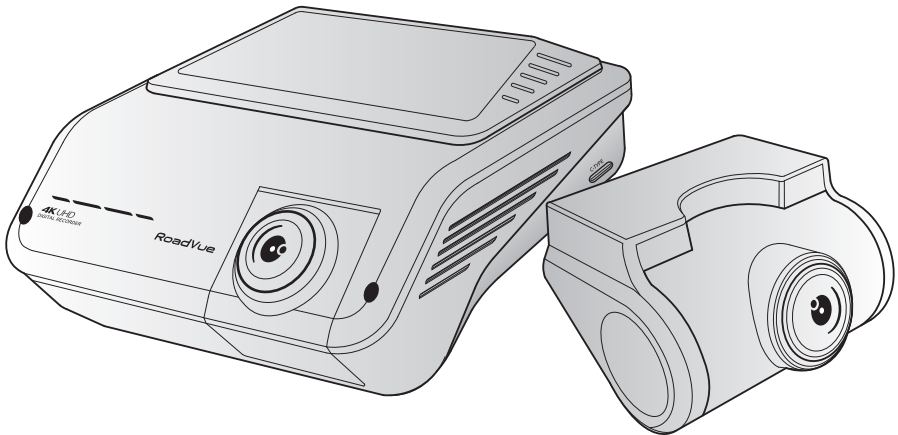

www.roadvue.com.au

Contents

01.Safety and precaution

Safety and Precaution	02
Precautions for Use	03

02.Product overview

1. Specification	04
2. Standard items	05
3. Accessories (sold separately)	05
4. Part names	06~07

03.Installing the products

1. Installing the front & rear camera	08~10
2. Connecting the power cable	11~12

04.How to Use

1. Button scenario	13
2. LED scenario	14
3. Recording Folder Configuration	15

05.How to use ROADVUE mobile APP

1. Installation	16
2. Wi-Fi Connection	17
4. Description of Functions	18
5. Real-time Video (Live View)	19
6. File list	20
7. Video Playback	21
8. Download Video	22
9. Setting	23~30

06.Using the PC viewer

1. Using the PC viewer (windows)	31
2. Using the PC viewer (MAC)	32

07. FCC Compliance Statement 33

Safety and Precaution

- Do not use damaged or altered power cables, and use only genuine products provided by ROADVUE. Use of an incorrect or damaged power cable may cause a safety accident such as fire, damage to the vehicle, or injury.
- Do not use at a voltage other than the rated voltage. Use at an incorrect voltage may cause a safety accident such as fire, damage to the vehicle, or injury.
- Do not arbitrarily connect the power cable to another device, as this may cause a fire or malfunction.
- Do not leave in an environment with high temperature, such as in an enclosed car or in a place where it will be exposed to direct sunlight, for an extended period of time. Failure to observe this requirement may cause a fire or malfunction.
- Do not install in a place where it will interfere with the driver's view, as this may cause a vehicle accident.
- Do not allow metal or flammable materials to enter the memory card slot or the place on the product where the power cord is inserted. Failure to observe this requirement may cause electric shock or fire.
- Do not operate the product with wet hands. This may cause electric shock.
- Please do not operate the dashcam while driving, as this may cause a vehicle accident.
- Do not arbitrarily install a constant power supply, as this may cause a product or vehicle malfunction. Be sure to get help from a professional installation engineer.
- Do not arbitrarily disassemble or alter the product. This may cause damage or data loss.
- Do not expose the product to direct sunlight or intense light. The lens or internal circuitry may fail permanent physical damages may result if it is operated or stored out of the specified temperature ranges. Such damages are not covered by the warranty.

Precautions for Use

- A dashcam is an auxiliary device that takes images and records them in a storage device in specific situations when a vehicle is driving or parking.
- Do not operate the product while driving a vehicle. Distraction while driving may cause accidents and result in injury or death.
- Recorded videos are deleted over time Because it uses a storage device (Micro SD card) with a limited storage capacity, if the storage device exceeds the capacity during recording, the oldest videos will be deleted sequentially.
- Do not remove SD card or turn off the power cable during the firmware update. It may cause malfunction or loss of data.
- In the event of an accident, turn off the dashcam power and remove the Micro SD card. If you continue to use it without removing the Micro SD card, the recorded video may be deleted over time. If it is difficult to remove the Micro SD card, you may turn off the power from the dashcam.
- Use of genuine ROADVUE memory card is recommended. Failure to use genuine SD card may cause error or malfunction.
- Real-time recording and playback via Wi-Fi could be delayed depending on the specifications of your smart device.
- Depending on the impact detection sensitivity setting in the product (normal, sensitive, insensitive, etc.), if the impact intensity is less than the set value, the impact image may not be stored in the event folder or the parking folder.
- Motion detection is initiated by an image sensor software. Errors may occur depending on the surrounding environment and the voltage of the car.
- If the GPS signal is good, ADAS will activate when the speed of the car is above the set speed. The surrounding environment may cause errors.

1. Specification

Model name	ROADVUE RV11
Resolution	Front : 4K UHD 3840x2160p @ 30fps Rear : Full HD 1920x1080p @ 30fps
Image sensor	Front : SONY STARVIS 8M Image Sensor Rear : SONY STARVIS 2M Image Sensor
Viewing angle	165° Wide Angle
Vibration sensor	3-axis acceleration sensor (3D, ±3G)
WiFi	5GHz & 2.4GHz Dual-band
GPS	Built-in GPS Synced with Google Maps, records the location and travelling speed of the vehicle
Recording mode	Driving (Normal, Hyperlapse) / Event (Impact) Parking (Timelapse, Motion Detection) / Audio Recording
Features	-ADAS (Advanced Driver Assistance Systems) -Eco mode (Energy saving parking mode) -Night Vision 3.0, Battery Protection, Thermal Protection
Storage	Micro SD 32GB ~ 512GB
Power input	DC 12 / 24 V supported
Alarm	Built-in speakers - Voice guide (buzzer sounds)
Operating temperature	14 – 140°F / -10 – 60°C
PC viewer	Win10 (64Bit or higher) / Mac (MacOS 11.0 or higher)
Mobile application	Android 6.0 / iOS 13.0 or higher

2. Standard items

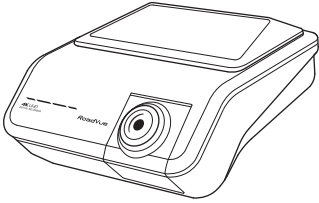

Front camera (Mount)

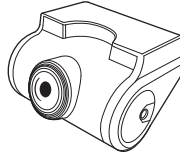

Rear camera



MicroSD Card



WiFi USB dongle
(5GHz)



Rear camera cable

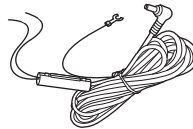

Hardwiring cable

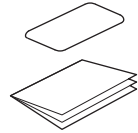

Quick start &
Electrostatic sticker

3. Accessories (sold separately)

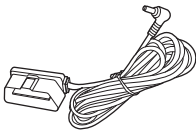

OBDII Power cable



Car charger

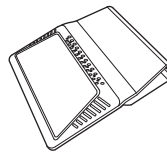

Cable cover mount

4. Part names

4-1. Front camera

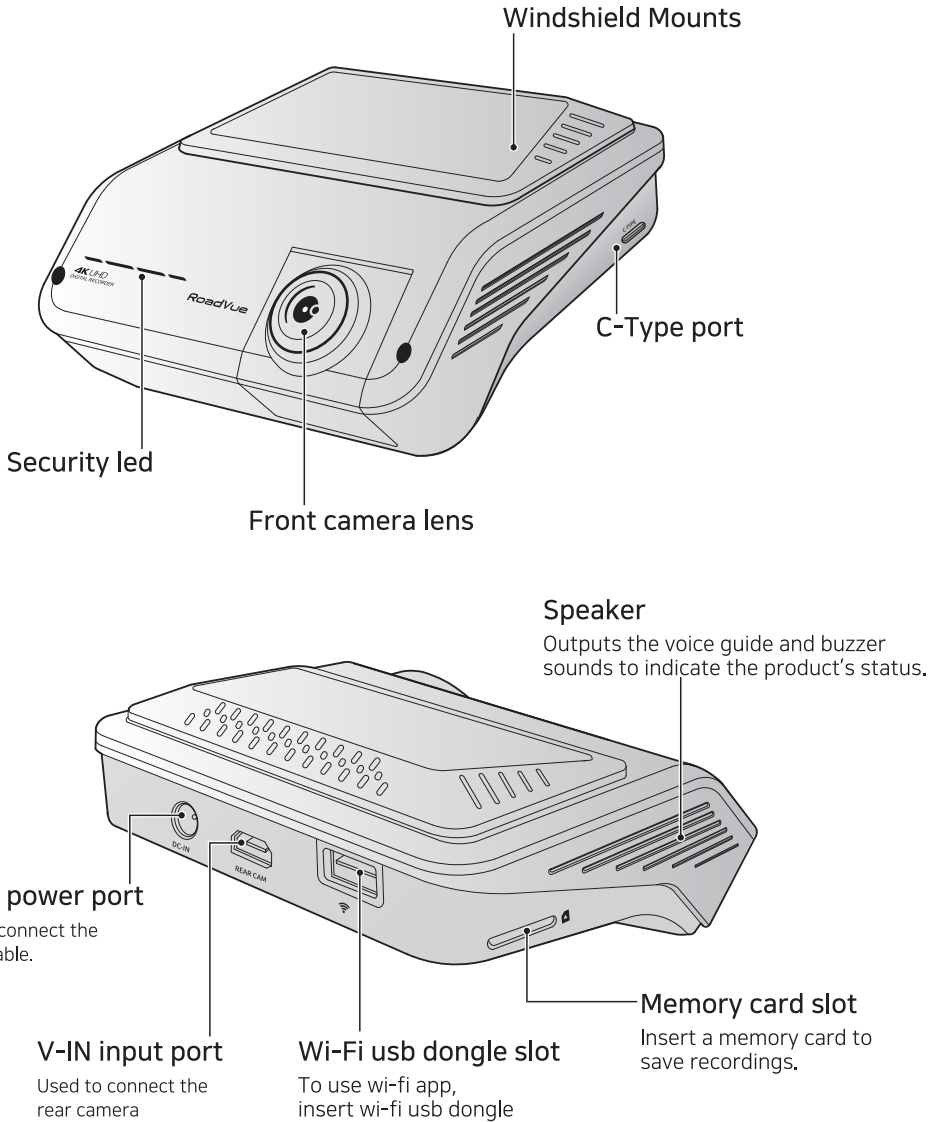

4-1. Front camera

- For more information about Button Scenario, refer to page 13.
- For more information about LED Scenario, refer to page 14.

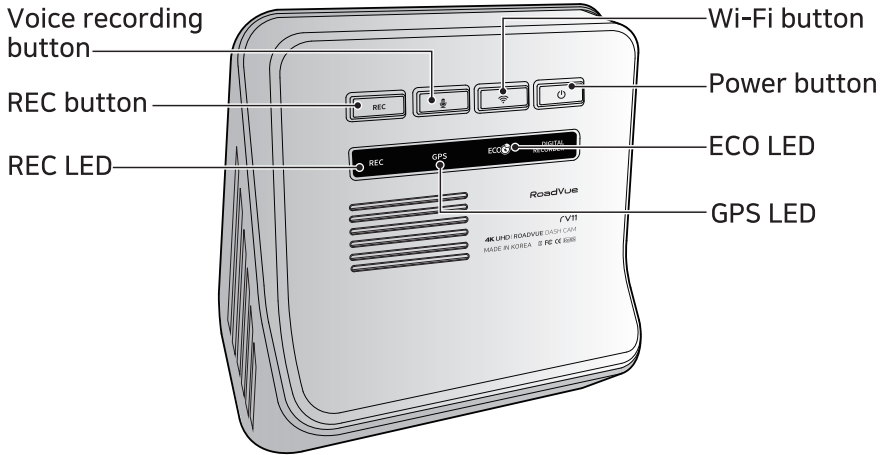

4-2. Rear camera

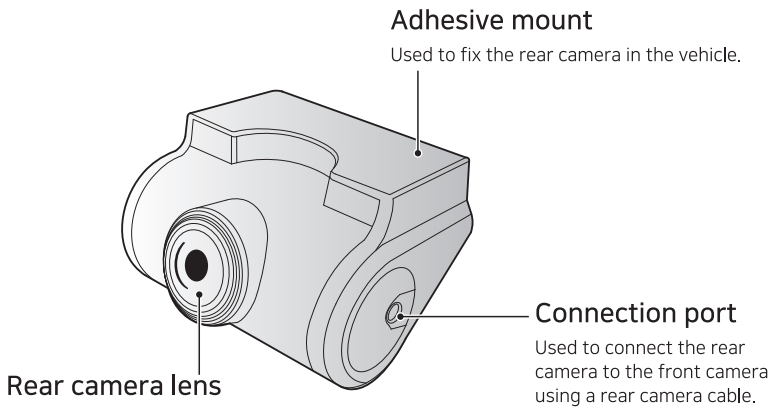

1. Installing the front & rear camera

1-1. Selecting an installation location

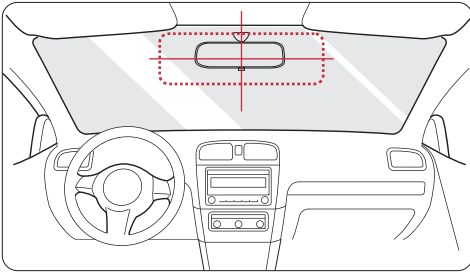

Use dry cloth to wipe the area on the windscreen where the device will be installed on it.

Make sure to install the device where the vision will not be blocked during driving.

• Caution

If a GPS navigation device is installed on the dashboard, its placement may affect GPS reception depending on the installation location of the dashboard camera.

Adjust the installation positions of the GPS navigation device and the dashboard camera to ensure they are at least 20cm (about 8 inches) apart.

1-2. Inserting the memory card

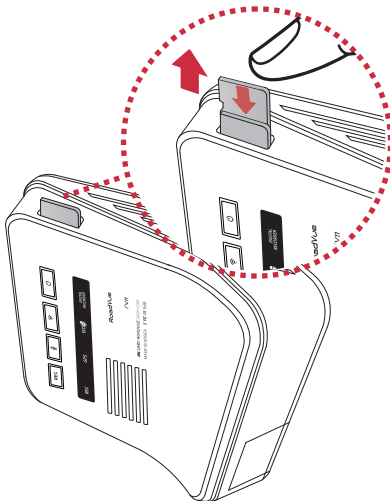

To insert the memory card into the memory card slot, ensure that the metal contacts on the memory card are facing toward the product's mount, and insert it into the slot until you hear a click.

Before removing the memory card, ensure that the product is turned off. Gently push the bottom of the memory card with your fingernail to release it, and then remove it from the product.

1-3. Remove the protective film

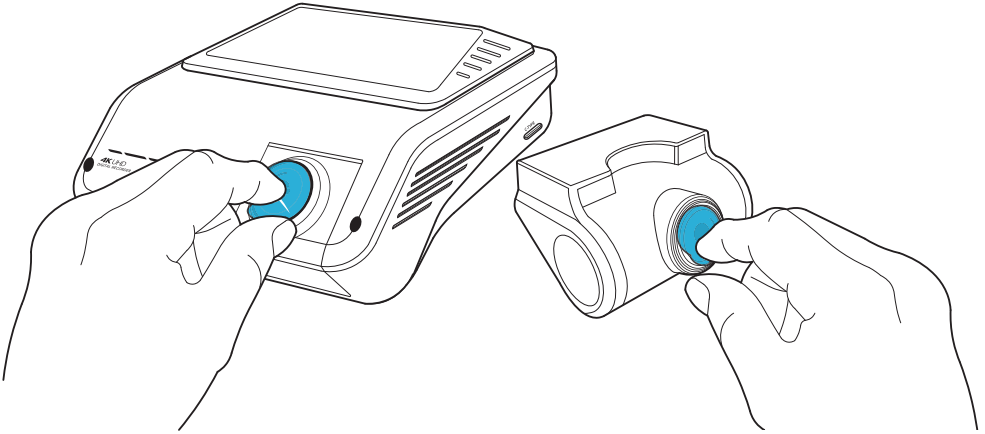

Carefully remove the protective film from the front and rear cameras.

1-4. Securing the product

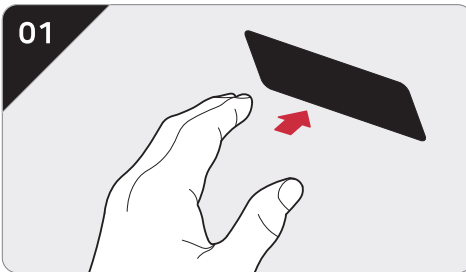

After removing the protective film from the Electrostatic sticker (black), attach it to the desired installation position.

1-4. Securing the product

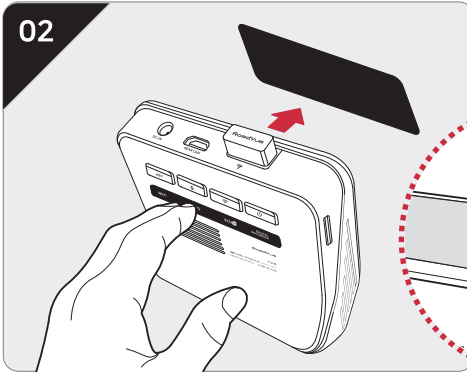

After removing the protective film from the Electrostatic Sticker(black), attach it to the desired installation position.

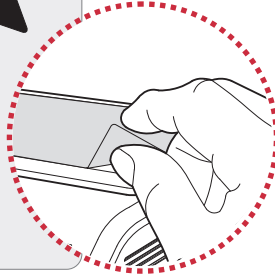

1-5. Connecting the rear camera cable & power cable

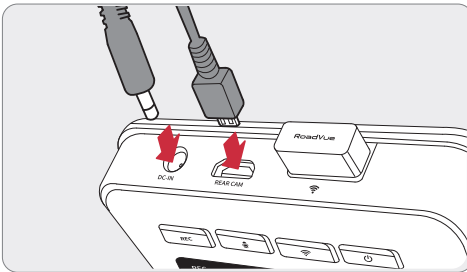

Connect one end of the rear camera cable to the front camera's V-IN port.

Connect the power cable to the product's DC-IN power connector and start the engine to make sure the product operates normally.

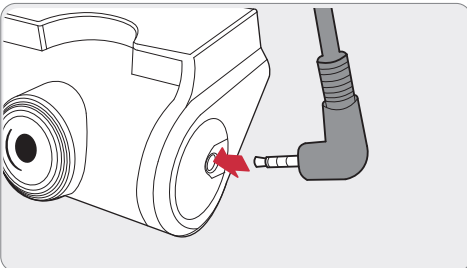

Connect the other end of the rear camera cable to the rear camera's connection port.

2. Connecting the power cable

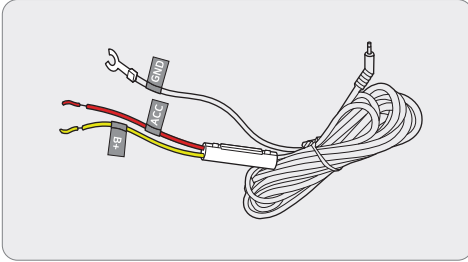

If you connect the product to the vehicle via the continuous power cable, the camera continues operating even when the vehicle is not operating (parking mode).

In parking mode, the camera detects impacts to the vehicle and nearby motion and records video.

- The continuous power cable must be professionally installed in the vehicle by a trained mechanic.
- When connecting the continuous power cable, pay special attention to wiring. If the wires are connected incorrectly, the product or the vehicle may be damaged.

2-1. Check and disconnect car fuses

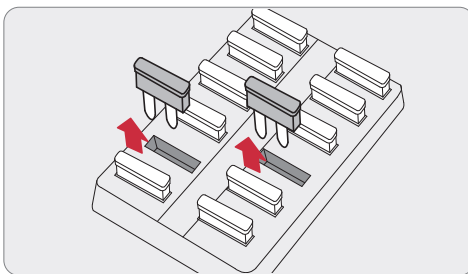

Open the fuse box, find the continuous power terminal (which supplies power when the vehicle is off) and the ACC terminal (which supplies power when the ignition status is "ACC ON") by using an electrical tester, and detach the fuses from the terminals.

- Find the vehicle's fuse box. Usually the fuse box is installed under the driver's seat. The location of the fuse box may differ depending on the make and model of the vehicle. To do it accurately, refer to the manual for your vehicle

2-2. Cable connection

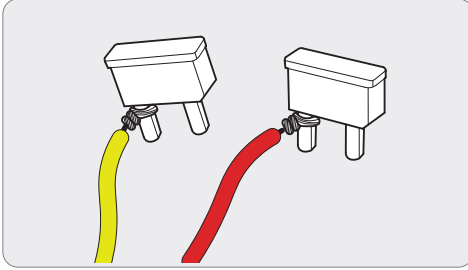

Connect the B+ wire to a fuse leg of the continuous power terminal and connect the ACC wire to a fuse leg of the normal (ACC) terminal

2-3. The fuses back into their locations

Place the fuses back into their locations on the fuse panel, connecting each fuse leg with the wire to the output contact point and taking care not to change the fuse position.

2-4. The GND wire

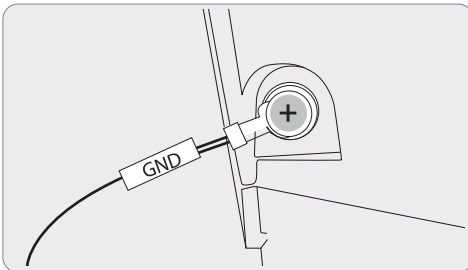

Connect the ground wire (the GND wire) to a bolt attached to a metallic part of the vehicle's body.

Normally, the metallic bolt that you can connect the ground wire to (the GND wire) is fitted nearby fuse box or the driver seat's door interior.

2-5. Connect the continuous power cable

Connect the continuous power cable to the product's DC-IN power connector and start the engine to make sure the product operates normally.

Once the product is powered on, the LED indicator and the voice guidance are turned on.

1. Button scenario

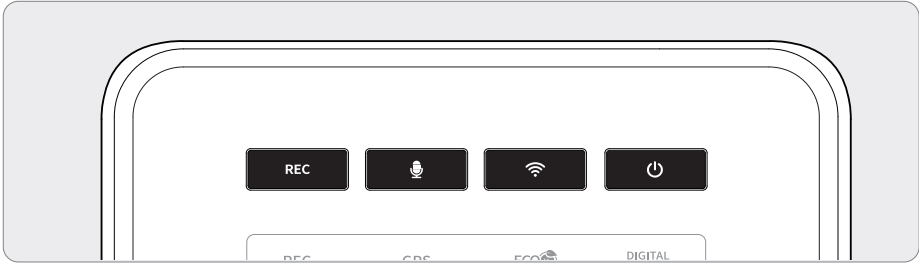

• Power button

	Short press	Power on
	Press and hold for 5 seconds	Power off

• Wi-Fi button

	Short press	Wi-Fi on/off
	Press and hold for 5 seconds	ECO Mode on/off

• Voice recording button

	Short press	Press to enable or disable voice recording
	Press and hold for 5 seconds	Press to enable or disable speaker

• REC button





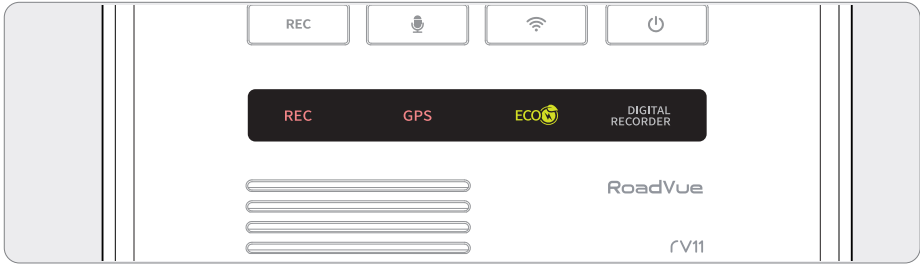



	Short press	Press to start manual recording.
	Press and hold for 5 seconds	SD card format

2. LED scenario





- The security LED status may vary depending on the selected mode.
- Refer to the following table to check the status of the product using the LED indicators.

• LED scenario

LED	LED status	Operation description
	 (light on)	Boot / Normal recording / SD card format
	 (flickers)	Event, Motion, Manual recording SD card uninserted status / Firmware upgrade
	 (light on)	Boot / SD card format
	 (flickers)	SD card uninserted status / Firmware upgrade
	 (light on)	Boot / Super energy saving mode(ECO) enable
	 (flickers)	SD card uninserted status / Firmware upgrade

3. Recording Folder Configuration

Folder name	Recording file
 normal	Driving recording , Hyper lapse
 event	Driving event , Parking recording , Parking motion , Time lapse
 manual	Manual recording

• Recorded Video File Name

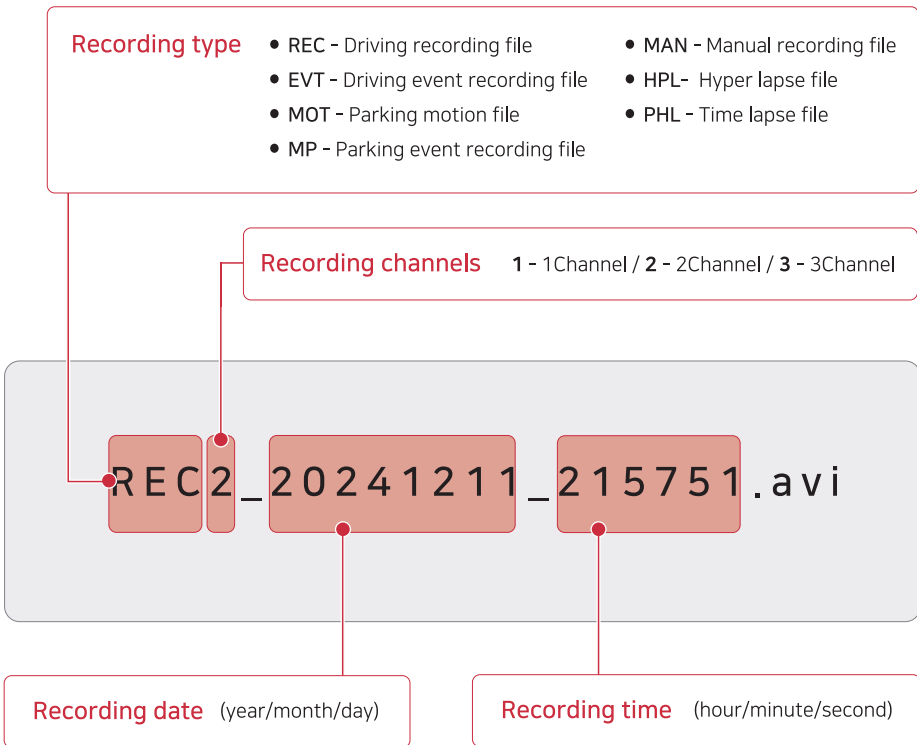

1. Installation

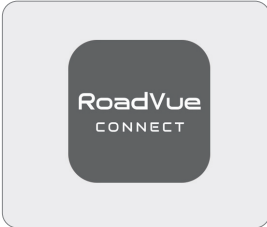

- Download the '**roadvue connect**' app from the 'Google Play Store' or the 'App Store' depending on your smartphone type.

2. Wi-Fi Connection

2-1

Activate the Wi-Fi function by pressing the Wi-Fi button  on the main body of the dashcam. " Wi-Fi Power is on " (Voice guidance)
Dashcam's initial setting is Wi-Fi on mode.

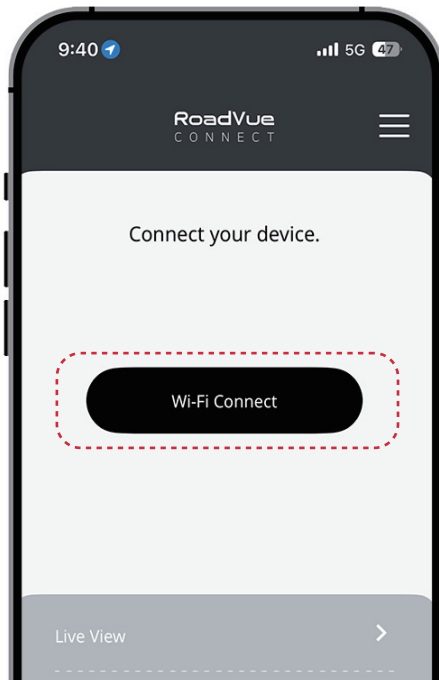

2-2

Run the ' Roadvue Connect ' app installed on your smartphone,
Click the ' Wi-Fi Connect ' button.

Wi-Fi Connection Scenario

- To connect with the smartphone, the Wi-Fi button must be pressed to activate it every time before connecting.
- **Wi-Fi Disconnection Conditions**
 - If there is no connection with the smartphone for 30 seconds,
 - Wi-Fi will disconnect 3 minutes after the smartphone is disconnected.

2. Wi-Fi connection

2-3

When the Wi-Fi function turns on, connect the Wi-Fi of your smartphone to the Wi-Fi network starting with 'ROADVUE'.

The Wi-Fi password is '**qwertyuiop**'

2-3-1. iOS

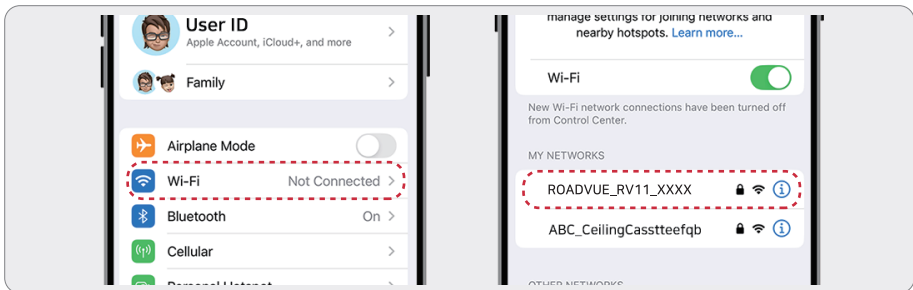

2-3-2. Android

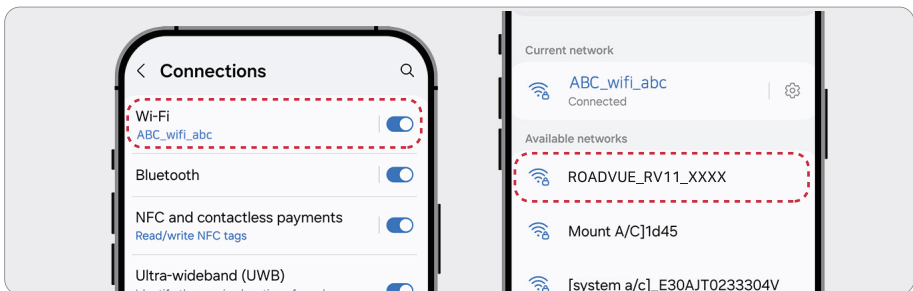

2-4

When the Wi-Fi is connected between your smartphone and the product, go back to the app. Press the "Wi-Fi Connect" button

3. Description of Functions

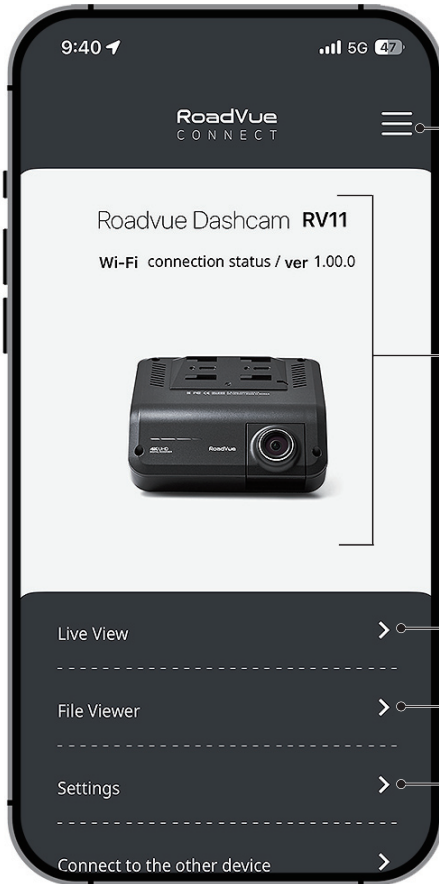

3-2. Menu

- Downloaded Video
- Firmware Download
- App Info

3-2. Product

You can check the product image, product name, and the current and latest versions of the product.

3-3. Live view

You can check the real-time video of the connected dashcam.

3-4. File Viewer

You can check the recorded video of the connected dashcam.

3-5. Setting

You can change the settings of the connected dashcam.

4. Real-time Video (Live View)

- On the main screen, tap the Live View button that provides real-time video. This offers a number of functions including front and rear real-time video, mounting angle setting, and ADAS guide lines.



• 4-1. Time, date display

• 4-2. ADAS guide lines

• 4-3. Front/Rear Switching

You can choose either front and rear real-time video.

• How to set the ADAS guide line

Please adjust the camera angle so that the yellow guide line aligns with the end of the vehicle's bonnet.

(If the guide line does not align, an ADAS error may occur.)

5. File list

- Tap the File List button on the main screen. A list of recorded videos is displayed.

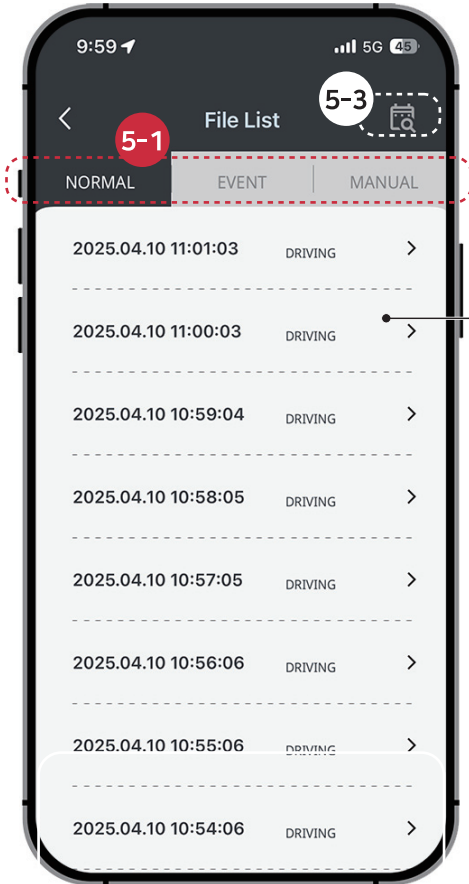

• 5-1. Menu

Normal	Driving recording , Hyper lapse
Event	Driving event , Parking recording , Parking motion , Time lapse
Manual	Manual recording

• 5-2. Played file

The background color of the played file will change.

• 5-3. Search recorded file

Press the calendar icon at the right top will open the search screen.

You can search for recorded files by date and time.

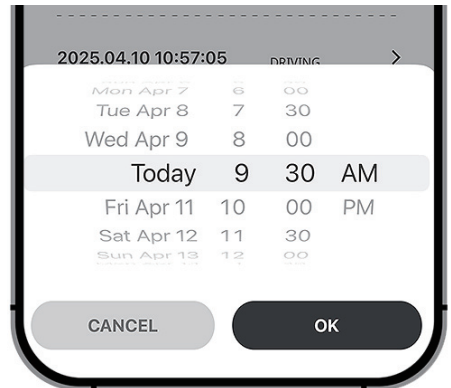

6. Video Playback

- Clicking on the recorded video list will play the video.

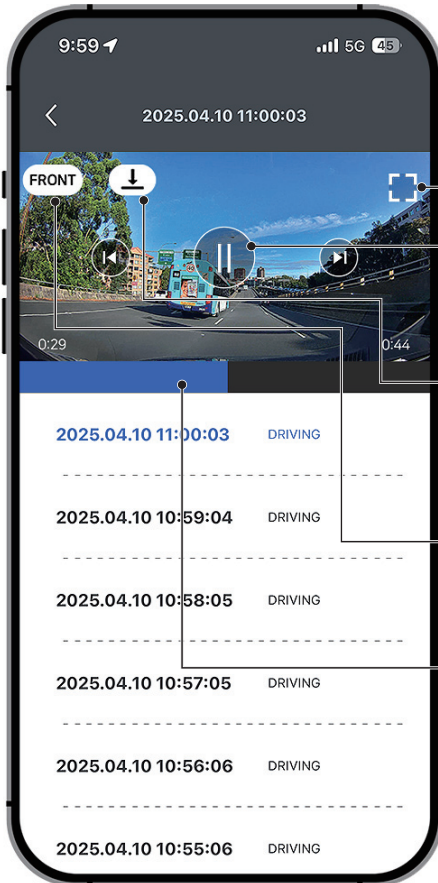

• **6-1. Full screen**

• **6-2. Play icon**

You can stop, play, or skip to the next or previous video in the currently playing video.

• **6-3. Video download**

Downloads the currently playing video. The downloaded video is saved on your smartphone.

• **6-4. Front/Rear Switching**

You can choose either front or rear vide

• **6-5. Playing position**

It marks the position in the currently playing video. You can drag and drop with your finger.

7. Download Video

- Tap the Download icon on the playback screen.
It provides a list of archived videos, which you can play or share.

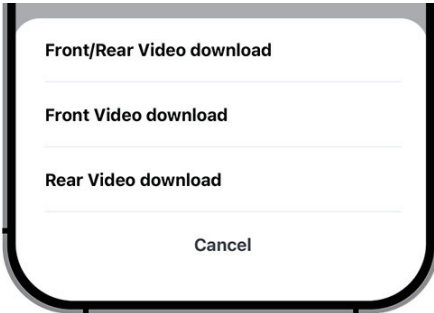

7-1. Front/Rear download

Tap the front camera, rear camera, or all cameras button to download the desired video file.

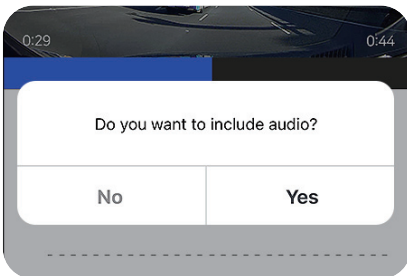

7-2. Download include audio

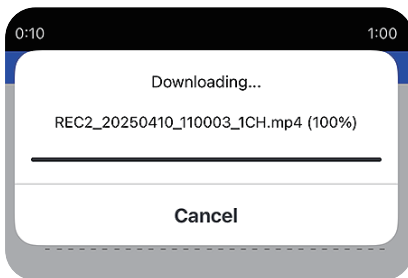

7-3. Download complete

The downloaded video files will be saved in your smartphone gallery or you can also check them in the file list 'storage'.

8. Setting

- Tap the settings button on the main screen.
You can select the menu you want and adjust the settings.

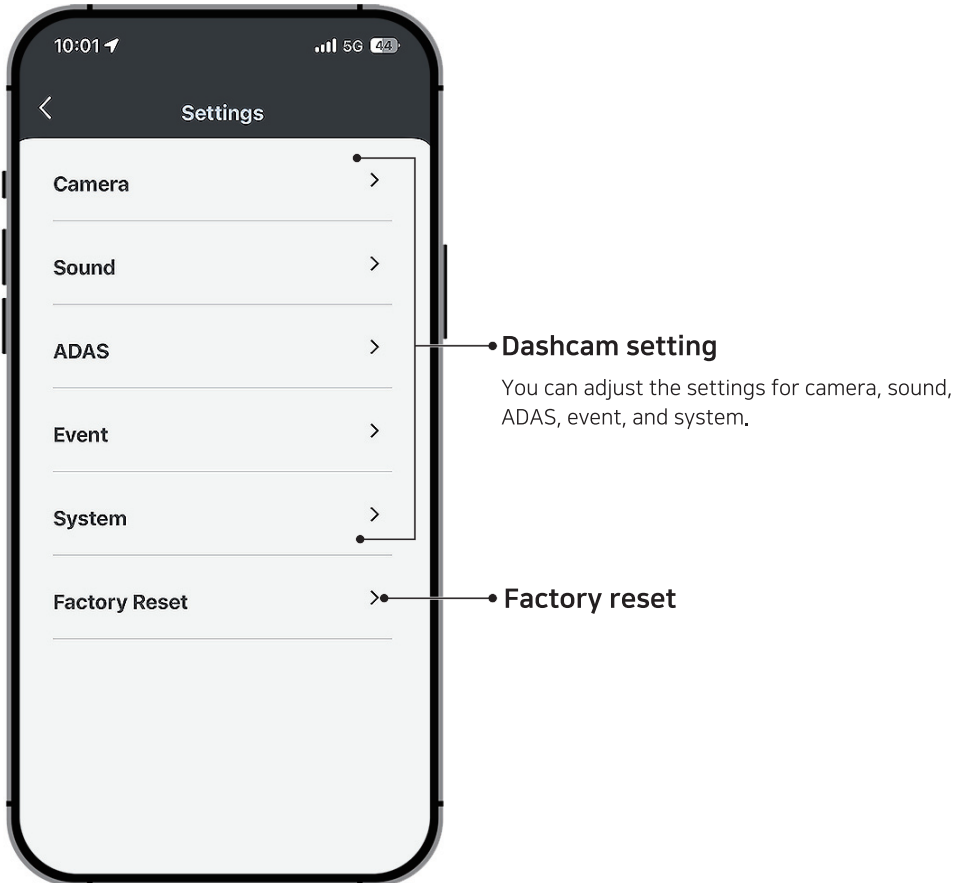

- When you change the dashcam setting, the memory card may be initialized, and a pop-up appears over the app during initialization. Please pay attention to that pop-up.

8-1. Setting - Camera

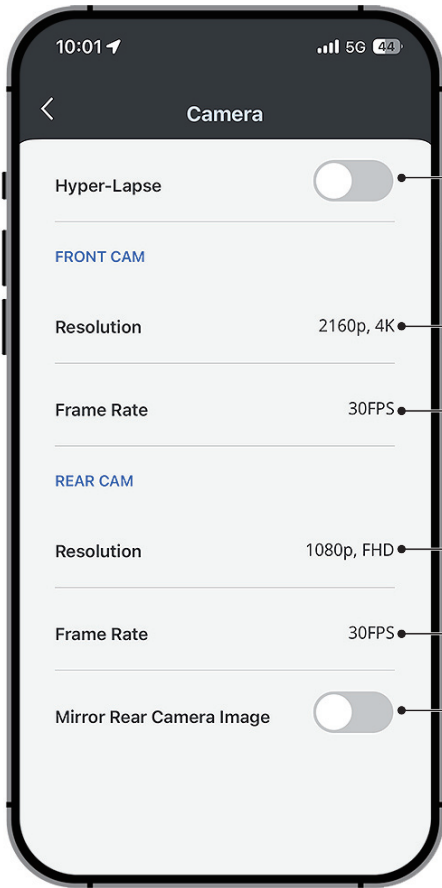

• 8-1-1. Hyper-Lapse on/off

Hyper-lapse saves the video at a rate of 1 frame per second. when an event or impact occurs, recording frame rate switches automatically to 30 fps to provide clearer images of important moments.

• 8-1-2. Front camera information

• 8-1-3. Rear camera information

• 8-1-4. Mirror Rear Camera Image

8-2. Setting-Sound

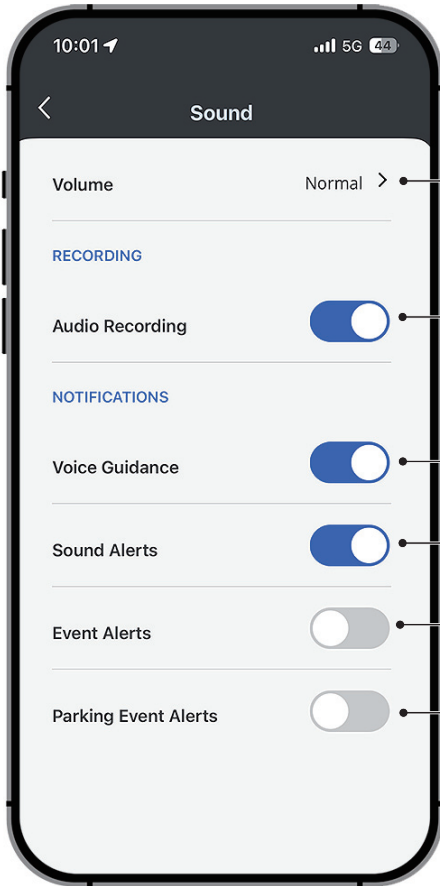

8-2-1. Speaker Volume

You can adjust the speaker volume in three levels 'Low', 'Normal', 'High'.

8-2-2. Audio Recording on/off

8-2-3. Voice Guidance on/off

8-2-4. Sound Alerts on/off

8-2-5. Event Alerts on/off

8-2-6. Parking Event Alerts on/off

8-3. Setting-ADAS

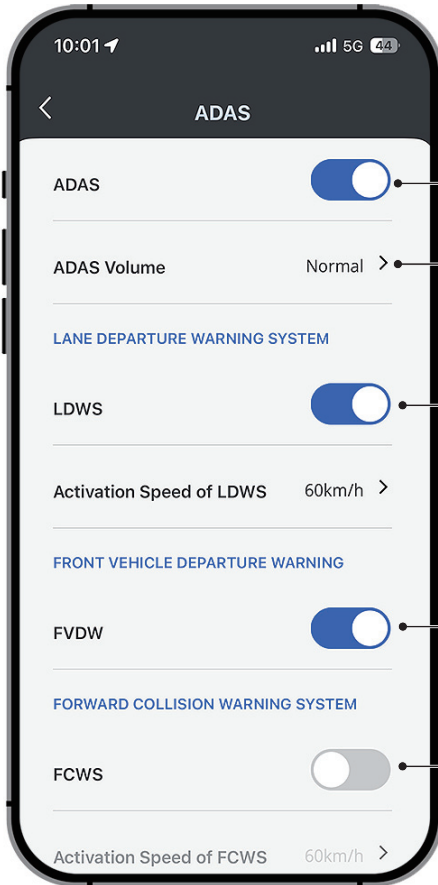

8-3-1. ADAS on/off

8-3-2. ADAS Volume

You can adjust the speaker volume in three levels 'Low', 'Normal', 'High'.

8-3-3. LDWS on/off

Lane Departure Warning System
The activation speed can be set to 60km, 80km, 100km with the default setting set to 60km.

8-3-4. FVDW on/off

Front Vehicle Departure Warning

8-3-5. FCWS on/off

Forward Collision Warning System
The activation speed can be set to 40km, 60km, 80km with the default setting set to 60km.

8-4. Setting-Event

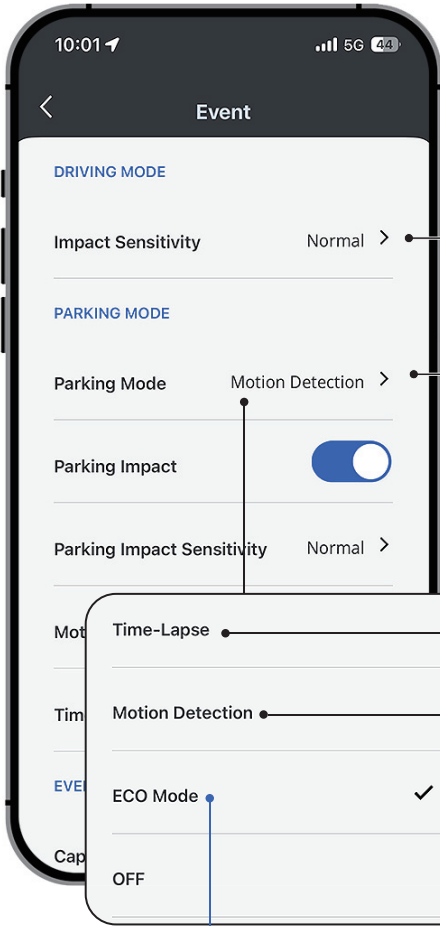

8-4-1. Impact Sensitivity

You can adjust the impact sensitivity (driving mode) in three levels 'Low', 'Normal', 'High'.

8-4-2. Parking Mode

Time-Lapse

Time-lapse saves the video at a rate of 1 frame per second. when an event or impact occurs, recording frame rate switches automatically to 30 fps to provide clearer images of important moments.

Parking mode	Normal	Time-lapse
Capacity	64GB	64GB
Frame	30fps	1fps
Recording time	About 8H	About 96H

Motion Detection

In parking mode, recording will only occur when motion is detected.

ECO Mode (Super energy saving mode)

It enters standby mode during parking, and immediately starts recording video upon impact detection.

Standby mode minimizes power consumption (Approximately 0.03W based on 12V)

8-4. Setting-Event

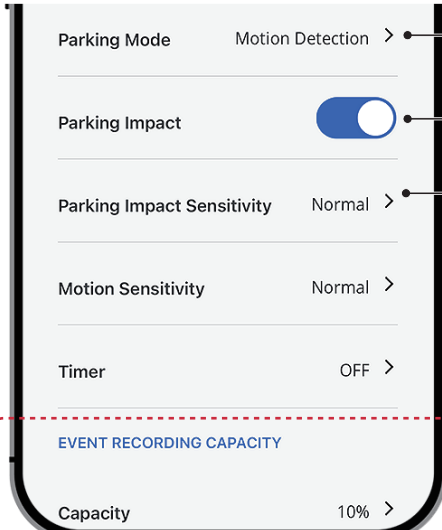

8-4-3. Parking Impact on/off

8-4-4. Parking Impact Sensitivity

You can adjust the impact sensitivity (parking mode) in three levels 'Low', 'Normal', 'High'.

8-4-5. Motion Sensitivity

You can adjust the motion sensitivity (parking mode) in three levels 'Low', 'Normal', 'High'.

8-4-6. Event Recording Capacity

Event data (impacts, motion, etc.) will be allocated within the memory card storage space.

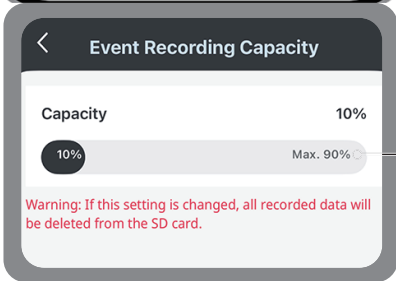

Warning

If this setting is changed, all recorded data will be deleted from the SD card.

8-5. Setting-System

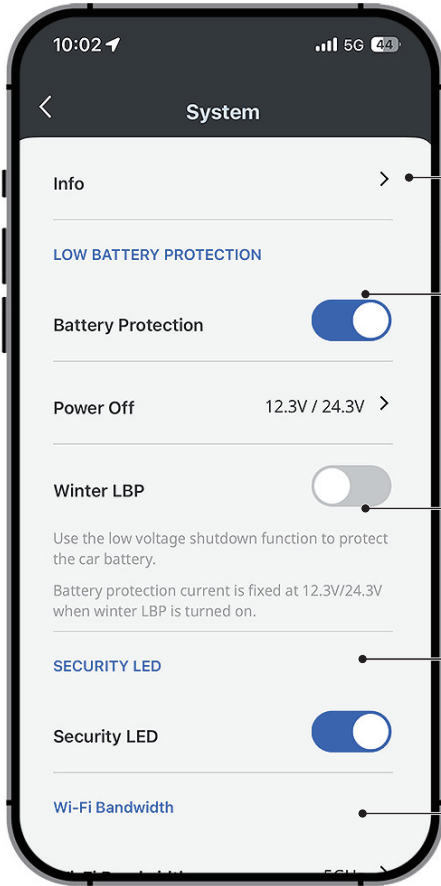

8-5-1. Info

Enter user information and check the dash cam details.

8-5-2. Low Battery Protection

In order to prevent a car battery from discharge during the parking mode, It has parking timer and voltage cut-off setting mode.
If the voltage is lower than the set volume, it executes the voltage cut-off automatically for preventing the car discharging.

8-5-3. Security LED

Turn the security LED(front camera) on or off in driving mode or parking mode.

8-6. Firmware Update from App

- DASHCAM connection is required for product recognition.
(Remember the last connected product)

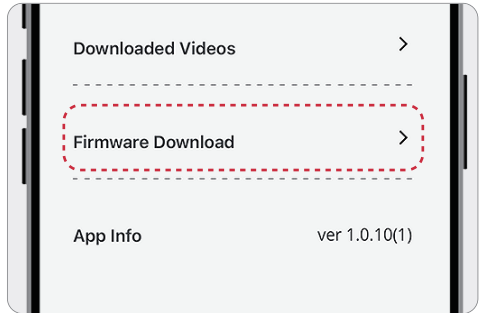
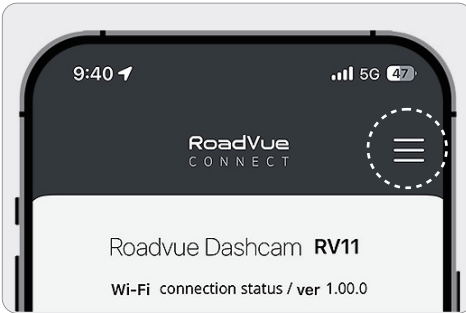

8-6-1. Step 1

Tap the F/W Update button on the main screen. A Firmware Download is displayed.

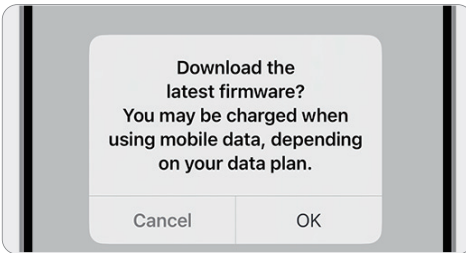

8-6-2. Step 2

Internet access will be restricted after a Wi-Fi connection
Please proceed with firmware download without connecting DASHCAM

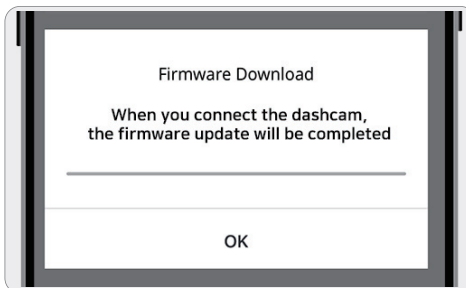

8-6-3. Step 3

When you connect the DASHCAM, the firmware will be updated, and the DASHCAM will be rebooted after completion

2. Using the PC viewer (MAC)



1	The main window in which the recorded video is played. (Front/rear video)
2	It allows you to load, play, or stop recorded video.
3	It displays a list of recorded videos
4	The G-Sensor value or driving speed is graphed.
5	If the recorded video contains GPS information, the location is displayed on the map.
6	Full-screen (Switch screens front, rear)
7	Dashcam settings
8	Video download

FCC Compliance Statement

This device complies with part 15 of the FCC rules. Operation is subject to the following two conditions: (1) This device may not cause harmful interference, and (2) this device must accept any interference received, including interference that may cause undesired operation

This equipment has been tested and found to comply with the limits for a Class B digital device, pursuant to part 15 of the FCC Rules. These limits are designed to provide reasonable protection against harmful interference in a residential installation. This equipment generates, uses and can radiate radio frequency energy and, if not installed and used in accordance with the instructions, may cause harmful interference to radio communications. However, there is no guarantee that interference will not occur in a particular installation. If this equipment does cause harmful interference to radio or television reception, which can be determined by turning the equipment off and on, the user is encouraged to correct the interference by one of the following measures:

- Reorient or relocate the receiving antenna.
- Increase the separation between the equipment and receiver.
- Connect the equipment into an outlet on a circuit different from which the receiver is connected.
- Consult the dealer or an experienced radio/TV technician for help.

FCC Caution

Any changes or modifications to the equipment not expressly approved by the party responsible for compliance could void your authority to operate the equipment.

This transmitter must not be co-located or operating in conjunction with any other antenna or transmitter.

FCC Radiation Exposure Statement

This equipment complies with FCC radiation exposure limits set forth for an uncontrolled environment. This equipment should be installed and operated with minimum distance 20 cm between the radiator and your body.



RoadVue
A U S T R A L I A

Model : RV11

Product : ROADVUE DASH CAM

www.roadvue.com.au