

RoadVue

ROADVUE RV9

User Guide

This product records videos while the vehicle is operating.
Read and follow the instructions in this guide to properly use and maintain the product.

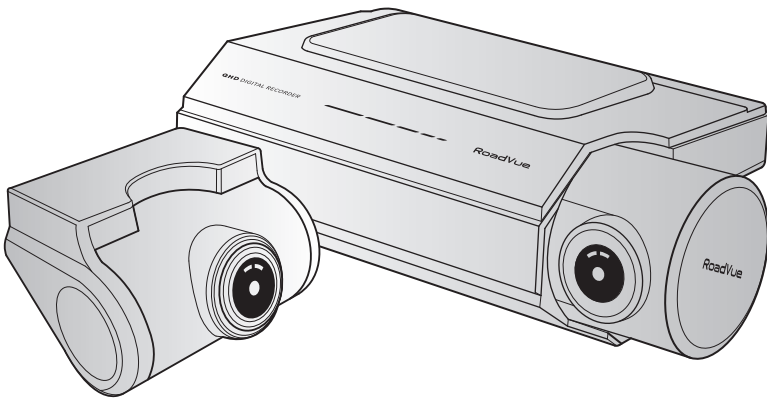

www.roadvue.com.au

Contents

01.Safety and precaution

Safety and Precaution	02
Precautions for Use	03

02.Product overview

2-1. Specification	04
2-2. Standard items	05
2-3. Accessories (sold separately)	05
2-4. Part names	06~07

03.Scenario

3-1. Button scenario	08
----------------------	----

04.Recording Folder Info

4-1. Recording Folder Configuration	09
4-2. Recorded Video File Name	09

05.Installing the products

5-1. How to install a fuse tap	10~11
5-2. How to install a Dashcame	12~17

05.How to use ROADVUE mobile APP

6-1. Installation / Wi-Fi connection	18~19
6-2. Main Home Screen	20
6-3. Real-time Video (Live View)	21
6-4. List of recorded video files	22
6-5. Video Playback	23
6-6. Download Video	24
6-7. Dashcam Environment Settings	25~29
6-8. Firmware Update from App	32

07.Using the PC viewer

1. Using the PC viewer (windows)	33
2. Using the PC viewer (MAC)	34

08. FCC Compliance Statement

35

Safety and Precaution

- Do not use damaged or altered power cables, and use only genuine products provided by ROADVUE. Use of an incorrect or damaged power cable may cause a safety accident such as fire, damage to the vehicle, or injury.
- Do not use at a voltage other than the rated voltage. Use at an incorrect voltage may cause a safety accident such as fire, damage to the vehicle, or injury.
- Do not arbitrarily connect the power cable to another device, as this may cause a fire or malfunction.
- Do not leave in an environment with high temperature, such as in an enclosed car or in a place where it will be exposed to direct sunlight, for an extended period of time. Failure to observe this requirement may cause a fire or malfunction.
- Do not install in a place where it will interfere with the driver's view, as this may cause a vehicle accident.
- Do not allow metal or flammable materials to enter the memory card slot or the place on the product where the power cord is inserted. Failure to observe this requirement may cause electric shock or fire.
- Do not operate the product with wet hands. This may cause electric shock.
- Please do not operate the dashcam while driving, as this may cause a vehicle accident.
- Do not arbitrarily install a constant power supply, as this may cause a product or vehicle malfunction. Be sure to get help from a professional installation engineer.
- Do not arbitrarily disassemble or alter the product. This may cause damage or data loss.
- Do not expose the product to direct sunlight or intense light. The lens or internal circuitry may fail permanent physical damages may result if it is operated or stored out of the specified temperature ranges. Such damages are not covered by the warranty.

Precautions for Use

- A dashcam is an auxiliary device that takes images and records them in a storage device in specific situations when a vehicle is driving or parking.
- Do not operate the product while driving a vehicle. Distraction while driving may cause accidents and result in injury or death.
- Recorded videos are deleted over time Because it uses a storage device (Micro SD card) with a limited storage capacity, if the storage device exceeds the capacity during recording, the oldest videos will be deleted sequentially.
- Do not remove SD card or turn off the power cable during the firmware update. It may cause malfunction or loss of data.
- In the event of an accident, turn off the dashcam power and remove the Micro SD card. If you continue to use it without removing the Micro SD card, the recorded video may be deleted over time. If it is difficult to remove the Micro SD card, you may turn off the power from the dashcam.
- Use of genuine ROADVUE memory card is recommended. Failure to use genuine SD card may cause error or malfunction.
- Real-time recording and playback via Wi-Fi could be delayed depending on the specifications of your smart device.
- Depending on the impact detection sensitivity setting in the product (normal, sensitive, insensitive, etc.), if the impact intensity is less than the set value, the impact image may not be stored in the event folder or the parking folder.
- Motion detection is initiated by an image sensor software. Errors may occur depending on the surrounding environment and the voltage of the car.
- If the GPS signal is good, ADAS will activate when the speed of the car is above the set speed. The surrounding environment may cause errors.

2-1. Specification

Model name	ROADVUE RV9
Resolution	Front : QHD 2560x1440p @ 30fps Rear : QHD 3460x1440p @ 30fps
Image sensor	Front : SONY STARVIS 5.1M Image Sensor Rear : SONY STARVIS 5.1M Image Sensor
Viewing angle	142° Wide Angle
Vibration sensor	3-axis acceleration sensor (3D, ±3G)
WiFi	Wi-Fi USB Dongle (2.4GHz)
GPS	Built-in GPS Synced with Google Maps, records the location and travelling speed of the vehicle
Recording mode	Normal (Driving, Hyperlapse, Timelapse) / Manual Recording Event(Impact, Motion Detection) / Audio Recording
Features	-Available by connecting the WiFi and C-type cable -ADAS (Advanced Driver Assistance Systems) -Auto Night Vision 3.0, Battery Protection, Thermal Protection
Storage	Micro SD 32GB ~ 512GB
Power input	DC 12 / 24 V supported
Alarm	Built-in speakers - Voice guide (buzzer sounds)
Operating temperature	14 – 140°F / -10 – 60°C
PC viewer	Win10 (64Bit or higher) / Mac (MacOS 11.0 or higher)
Mobile application	Android 6.0 / iOS 13.0 or higher

2-2. Standard items

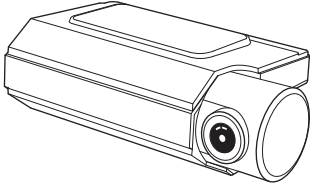

Front camera (Mount)

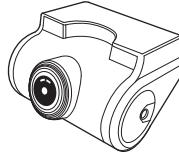

Rear camera



MicroSD Card



WiFi USB dongle



Rear camera cable

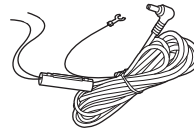

Hardwiring cable

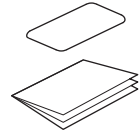

Quick start &
Electrostatic sticker

2-3. Accessories (sold separately)

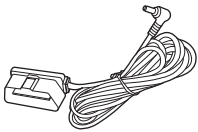

OBDII Power cable



Car charger

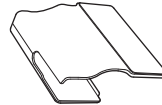

Cable cover mount

2-4. Part names

2-4-1. Front camera

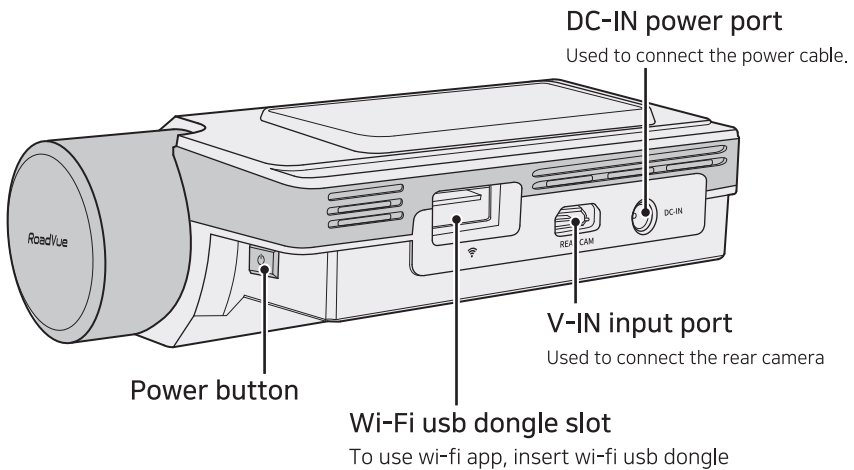
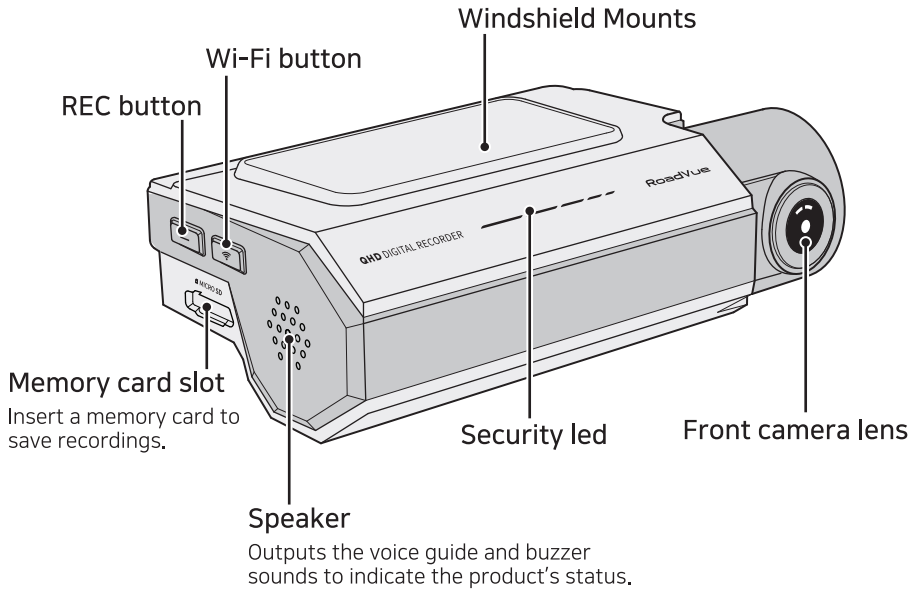

2-4-1. Front camera

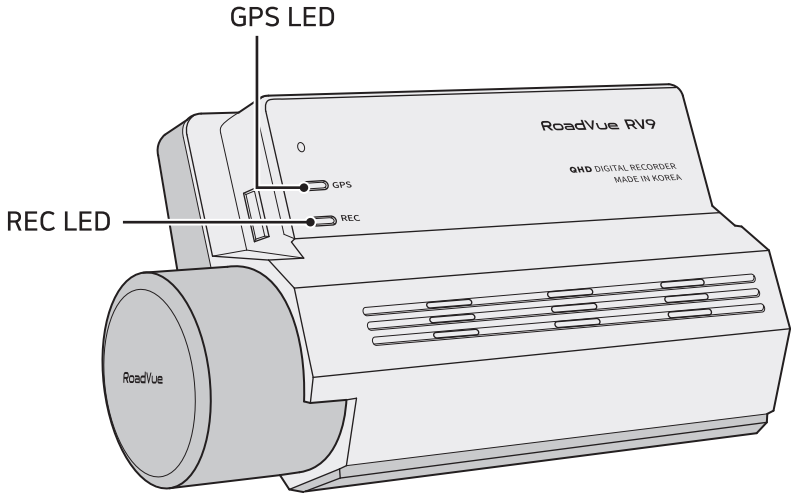

2-4-2. Rear camera

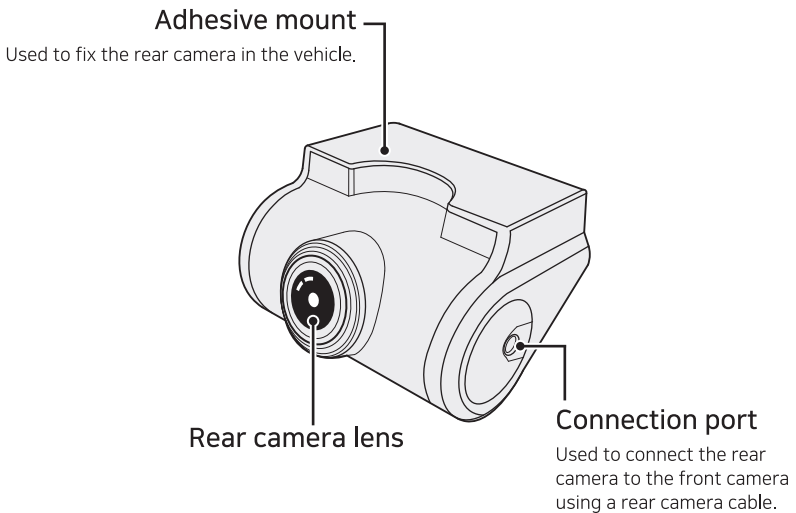

3. Button scenario

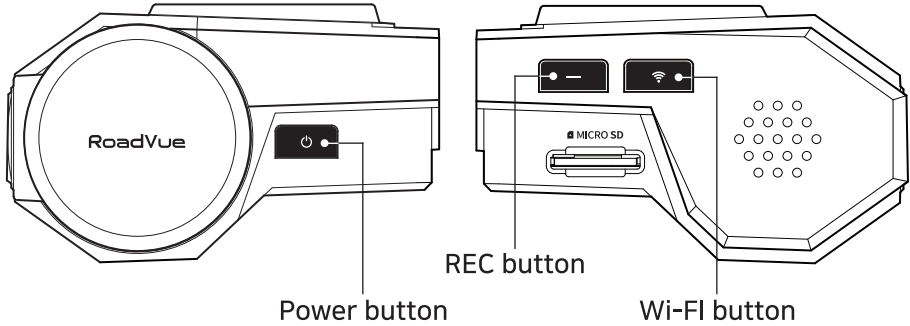

- Power button

	Short press	Power On
	Press and hold for 3 seconds	Power Off



- Wi-Fi button

	Short press	Power On / Off
---	-------------	----------------

- REC button

	Short press	Press to start manual recording.
	Press and hold for 5 seconds	SD card format

4-1. Recording Folder Configuration

Folder name	Recording file
 normal	Driving recording , Hyper lapse, Time lapse
 event	Driving event , Parking impact , Parking motion detection
 manual	Manual recording

4-2. Recorded Video File Name

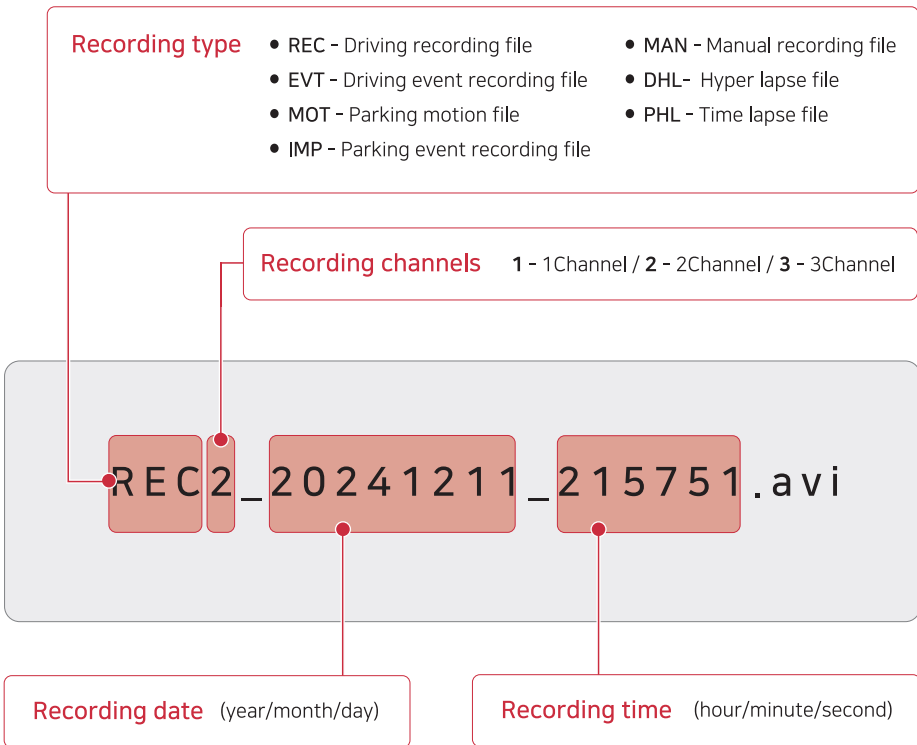

5-1. How to install a fuse tap

5-1-1.

Check the fuse box location

Before connecting any cables, find out where the vehicle's fuse box is located. For more details, refer to the owner's manual provided with the vehicle.

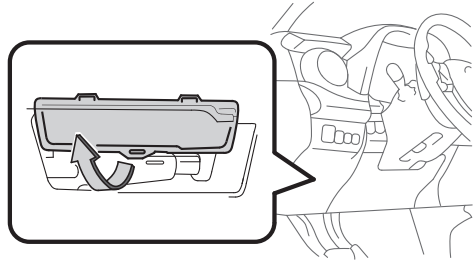

5-1-2.

Check for a fuse connected to battery (B+) and a fuse connected to ACC



Yellow (B+)

OBD, HAZARD LIGHT Fuse



Red (ACC)

USB, CIGAR(P/OUTLET) Fuse



- The location of the fuses may vary depending on the vehicle manufacturer or model. For more details, please refer to the owner's manual provided with your vehicle.
- Do not use fuses related to vehicle safety.

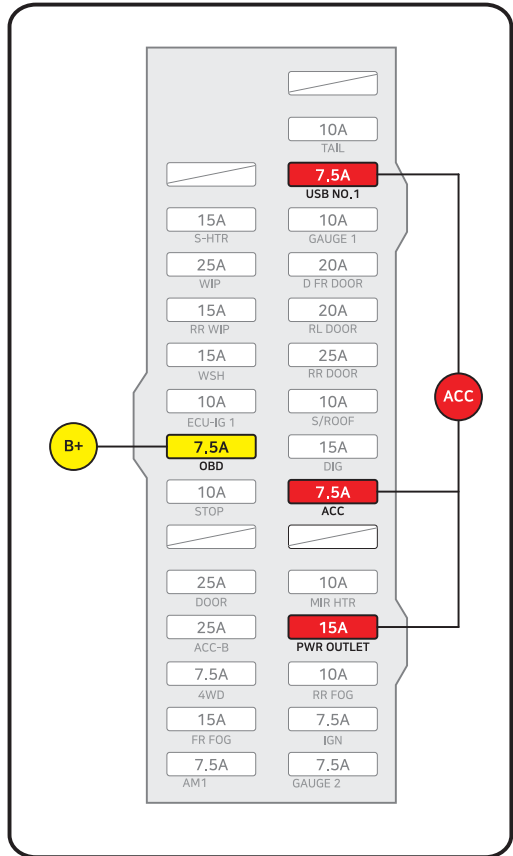

5-1-3. Fuse disconnect

After removing fuse panel cover, find a fuse that powers on when engine is turned on (ex. cigar fuse, P/outlet fuse and etc.) and another fuse that remains powered on after the engine is turned off. (ex.hazard light, interior light).

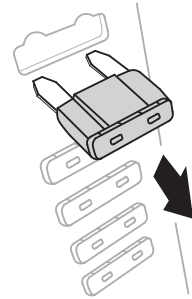

5-1-4. Fuse, Cable Connection

Connect the separated fuse to the ACC (red) and B+ (yellow) cables. After connecting as shown in the diagram, reinstall the fuse in its original position.

Yellow = 12V+ constant/B+

Red = ACC

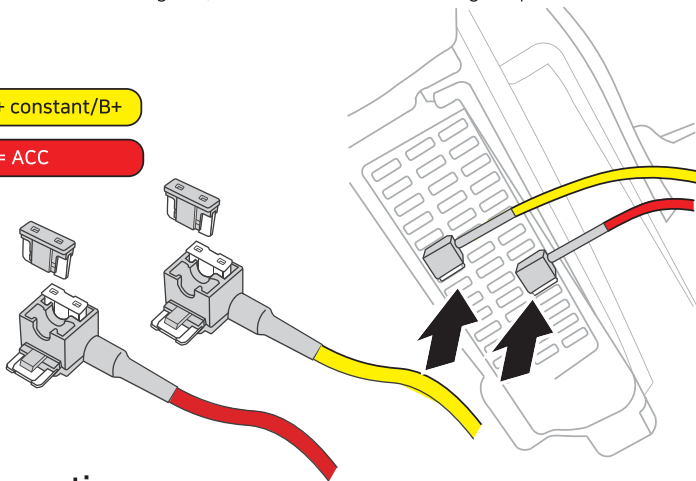

5-1-5. GND connection

The ring terminal ground wire(GND black) on the hardwire cable needs to be connected to a chassis ground.

It is recommended utilizing an existing 0mm factory bolt by loosening slightly and sliding the ground terminal between the bolt and the chassis. Tighten the 10mm bolt afterwards.

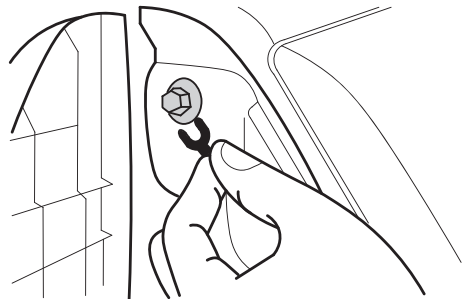

- In most cases, there is a metal bolt near the fuse box or inside the driver's side door where a ground ('GND') wire can be connected.

5-2. How to install a Dashcam

5-2-1. Setting the Front Camera Position

The front camera should be installed on the left or front of the rearview mirror where it does not obstruct the view. Please avoid installing it on the driver's seat where it may obstruct the driving view

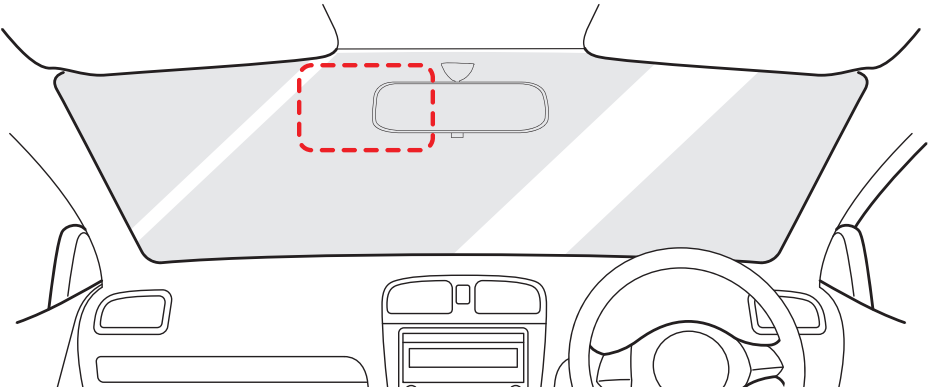

5-2-2. Harness installation routing

Pre-check Before connecting the harness cable, connect the dashcam to check if there is any problem with the dashcam and the cables.

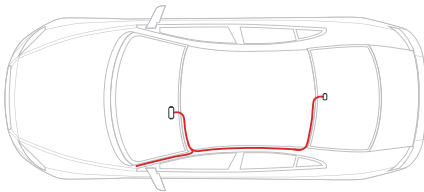

(Driver Side Fuse Box)

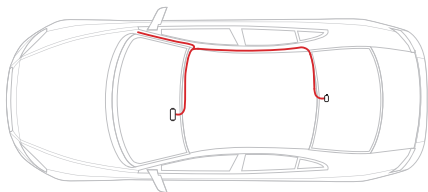

(Passenger Side Fuse Box)

5-2-3. Connecting Cable & Power

Rear camera cable (B) + (A) should be tucked into the headlining at the closest point of the rearview mirror towards the A-Pillar.



- The right-angled connector (B) plugs into the front dash camera, the connector to run through the vehicle to connect into the rear camera (C) will be the straight stereo video jack

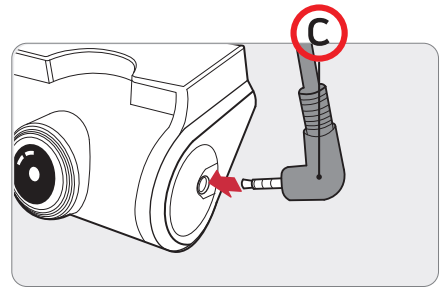
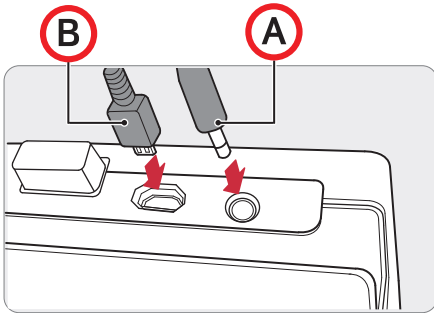

5-2-4.

Rear camera cable and Hardwire cable should be put wiring into the headlining at the closest point of the dashcam towards the vehicle's A-Pillar.

It is recommended to use cable ties to organize the wires by bundling them every 200mm.

To avoid interference with airbag deployment, do not route cables across or over the airbag. If necessary, route cables behind the airbag in the A-pillar and, if possible, follow the vehicle wiring harness.

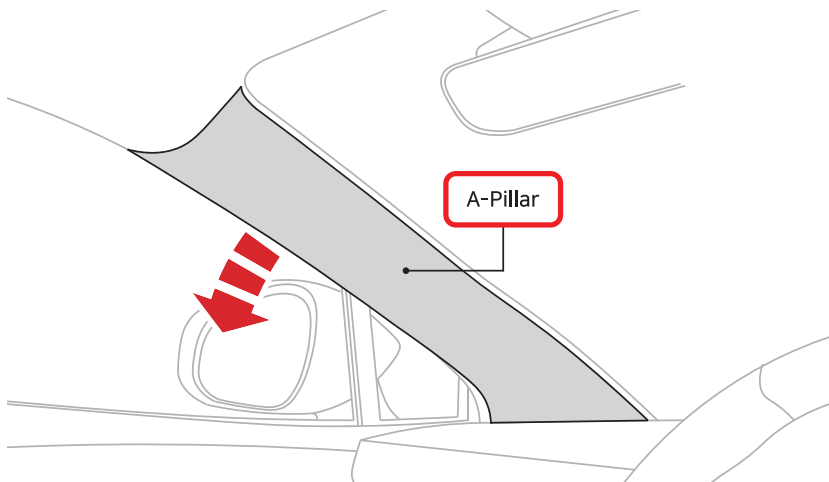

5-2-5.

Remove the A-pillar clip and plastic trim.

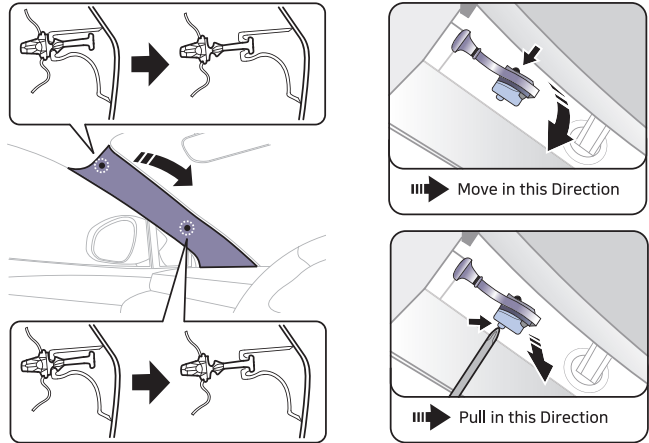

5-2-6. A-pillar wiring installation route

Route the wiring downwards along the A-pillar, and if necessary, remove the cover underneath the A-pillar to hide the wiring.

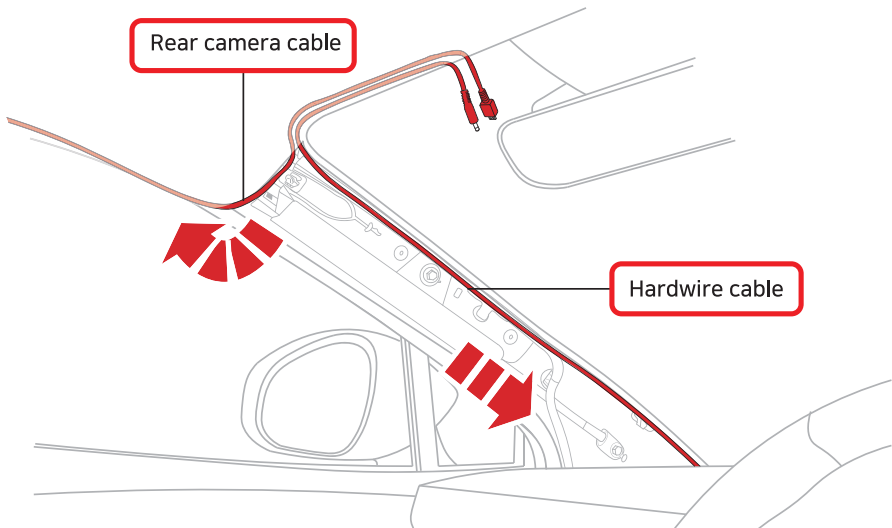

5-2-7.

To prepare the rear camera cable routing, remove the rubber seal from the upper A-pillar edge. Route the rear camera cable through the rubber seal and reinstall it.

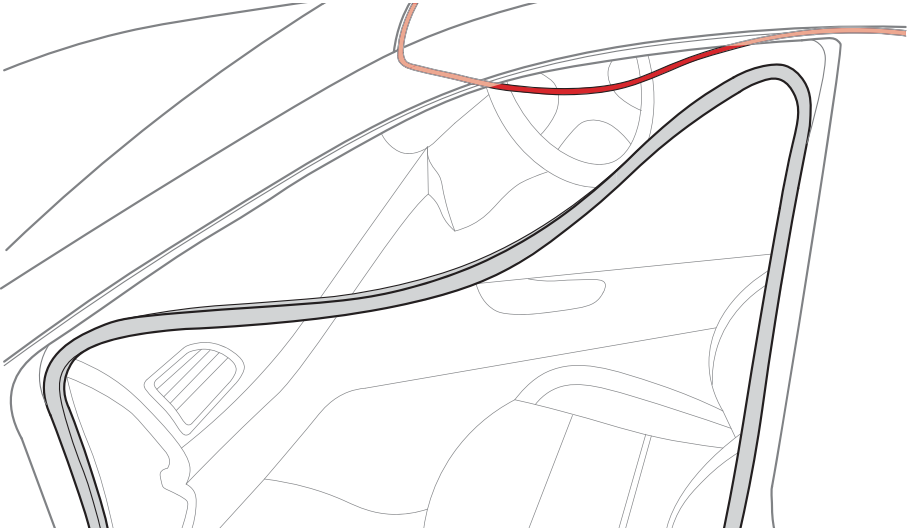
**5-2-8.**

Just like the installation method 7, remove the rubber seal for the rear camera cable all the way to the top of the rear seat A pillar, put the cable inside, and reinstall.

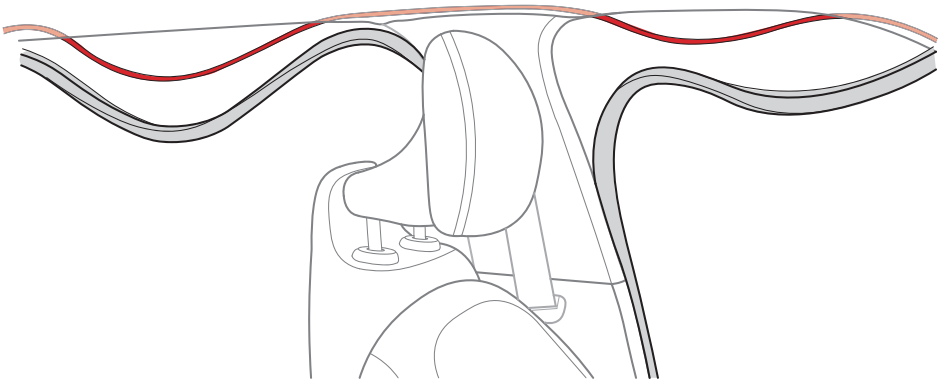

5-2-10. Sedan

Feed the rear camera cable towards the centre of the rear windshield and tuck the cabling under the roof lining so it is not visible for the customer.

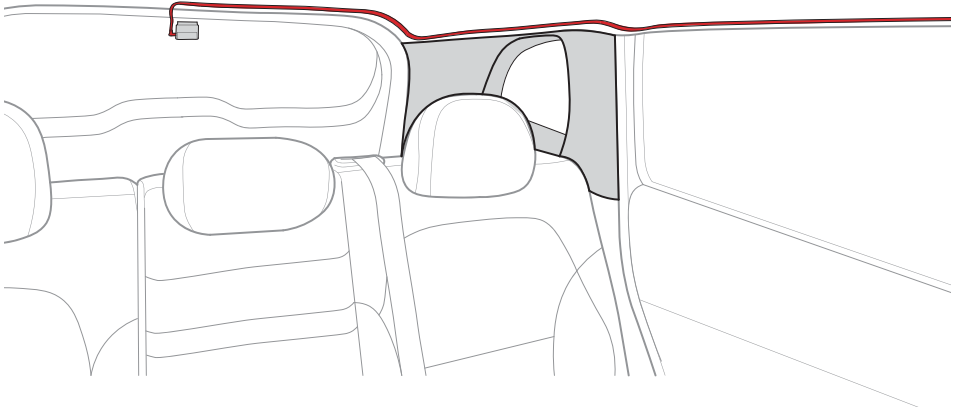

5-2-11. SUV / Hatch

Feed the rear camera cable towards the rubber grommet that connects the vehicle loom to the tailgate / hatch boot area. Remove tailgate / hatch inner trim skin to gain access to final camera destination.

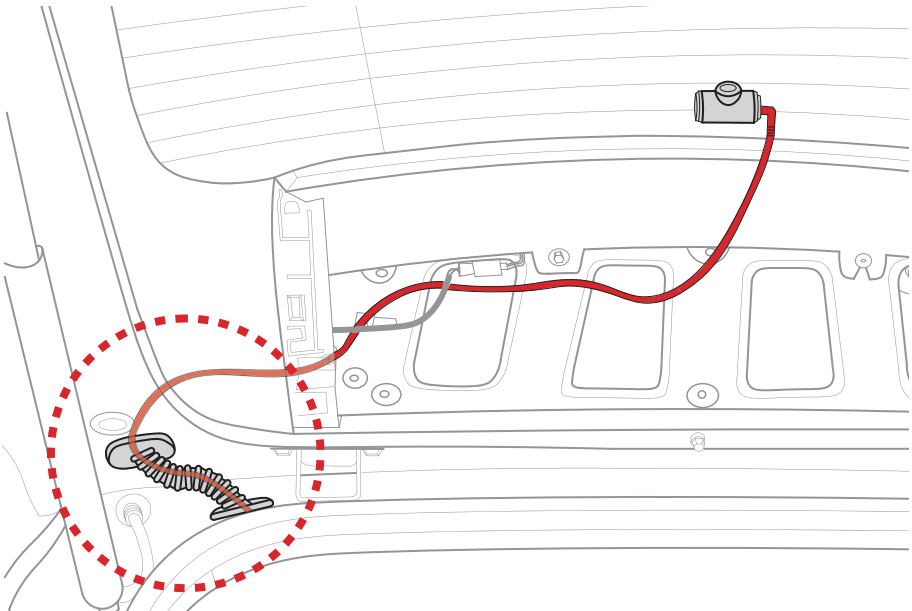

5-2-12.**Remove the protective film**

Carefully remove the protective film from the front and rear cameras.

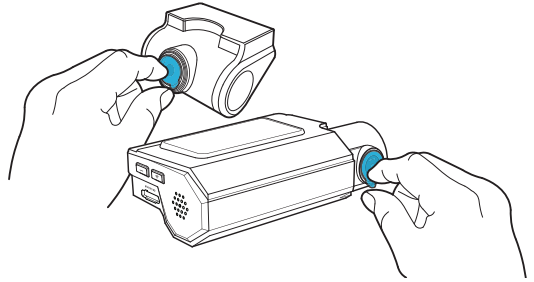
**5-2-13.****Connecting the Rear camera**

The rear camera position is at the top center of the rear window with the lens oriented toward the side without grid lines.

Same as the front windshield, remove any foreign matter and clean and dry the windshield before installation.

After all dust and moisture has dried sufficiently, install the rear camera.

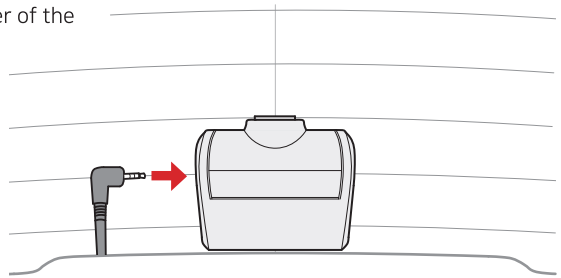
**5-2-14.****Connecting the front camera**

After removing the protective film from the Electrostatic sticker (black), attach it to the desired installation position.

Insert Micro SD card into the front camera. Connect to power cable and rear cable.

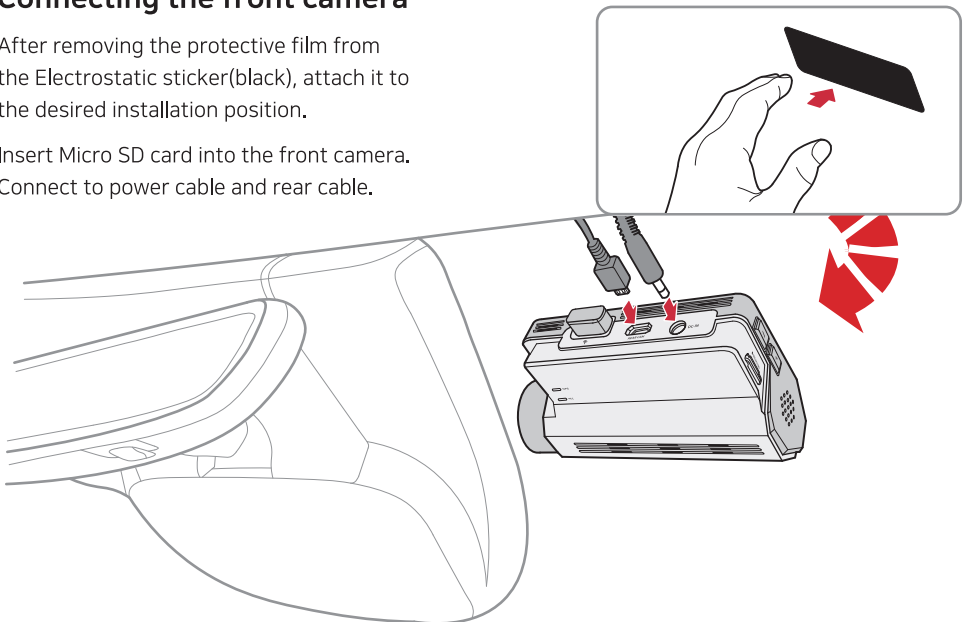

1. Installation

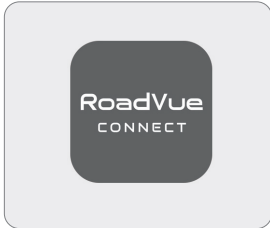

- Download the ' **roadvue connect** ' app from the 'Google Play Store' or the 'App Store' depending on your smartphone type.

2. Wi-Fi Connection

2-1

Activate the Wi-Fi function by pressing the Wi-Fi button  on the main body of the dashcam. " Wi-Fi Power is on " (Voice guidance)
Dashcam's initial setting is Wi-Fi on mode.

2-2

Run the ' Roadvue Connect ' app installed on your smartphone,
Click the ' Wi-Fi Connect ' button.

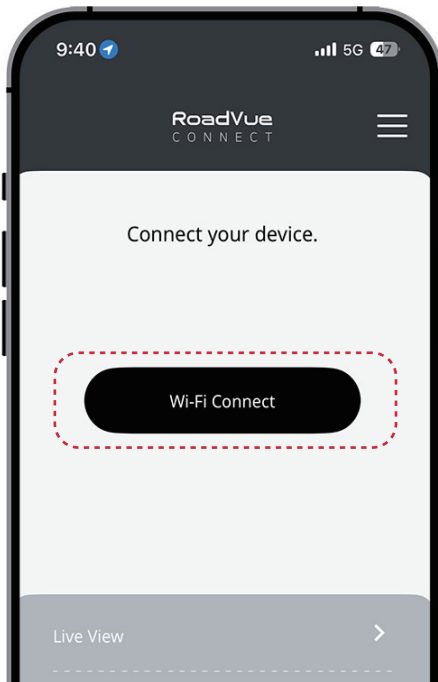

Wi-Fi Connection Scenario

- To connect with the smartphone, the Wi-Fi button must be pressed to activate it every time before connecting.
- **Wi-Fi Disconnection Conditions**
 - If there is no connection with the smartphone for 30 seconds.
 - Wi-Fi will disconnect 3 minutes after the smartphone is disconnected.

2. Wi-Fi connection

2-3

When the Wi-Fi function turns on, connect the Wi-Fi of your smartphone to the Wi-Fi network starting with 'ROADVUE'.

The Wi-Fi password is **'qwertyuiop'**

2-3-1. iOS

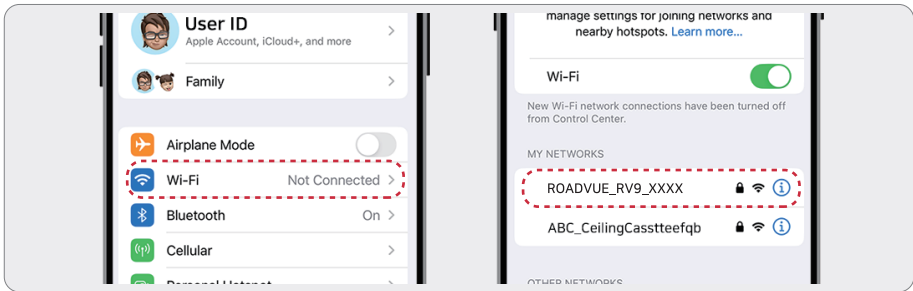

2-3-2. Android

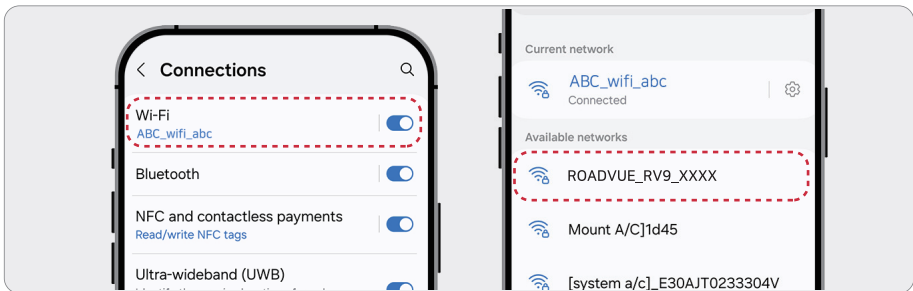

2-4

When the Wi-Fi is connected between your smartphone and the product, go back to the app. Press the "Wi-Fi Connect" button

3. Description of Functions

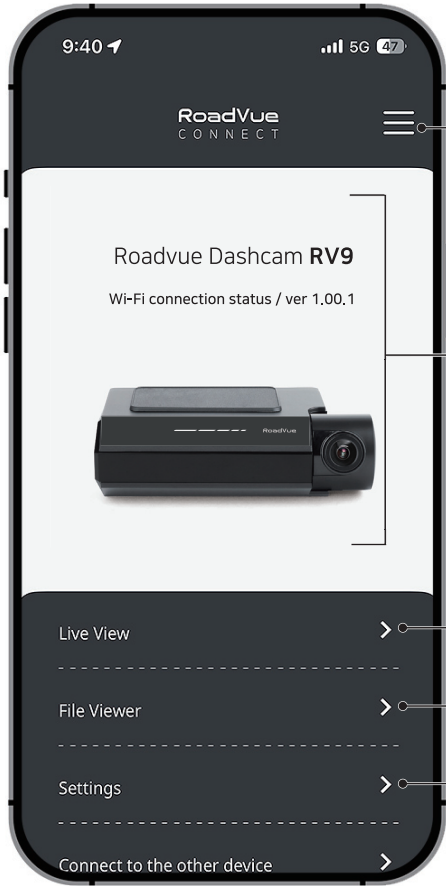

• **3-2. Menu**

- Downloaded Video
- Firmware Download
- App Info

• **3-2. Product**

You can check the product image, product name, and the current and latest versions of the product.

• **3-3. Live view**

You can check the real-time video of the connected dashcam.

• **3-4. File Viewer**

You can check the recorded video of the connected dashcam.

• **3-5. Setting**

You can change the settings of the connected dashcam.

4. Real-time Video (Live View)

- On the main screen, tap the Live View button that provides real-time video. This offers a number of functions including front and rear real-time video, mounting angle setting, and ADAS guide lines.



• 4-1. Time, date display

4-2. ADAS guide lines •

4-3. Front/Rear Switching •

You can choose either front and rear real-time video.

- **How to set the ADAS guide line**

Please adjust the camera angle so that the yellow guide line aligns with the end of the vehicle's bonnet.

(If the guide line does not align, an ADAS error may occur.)

5. File list

- Tap the File List button on the main screen. A list of recorded videos is displayed.

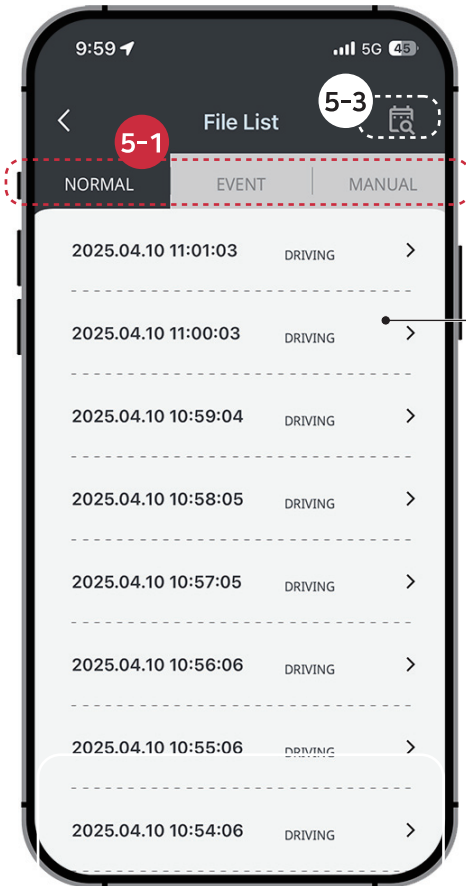

• 5-1. Menu

Normal	Driving recording , Hyper lapse
Event	Driving event , Parking recording , Parking motion , Time lapse
Manual	Manual recording

• 5-2. Played file

The background color of the played file will change.

• 5-3. Search recorded file

Press the calendar icon at the right top will open the search screen.

You can search for recorded files by date and time.

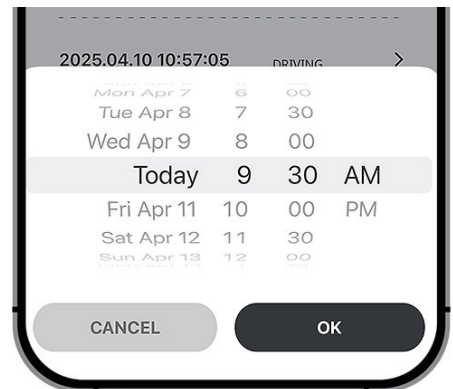

6. Video Playback

- Clicking on the recorded video list will play the video.

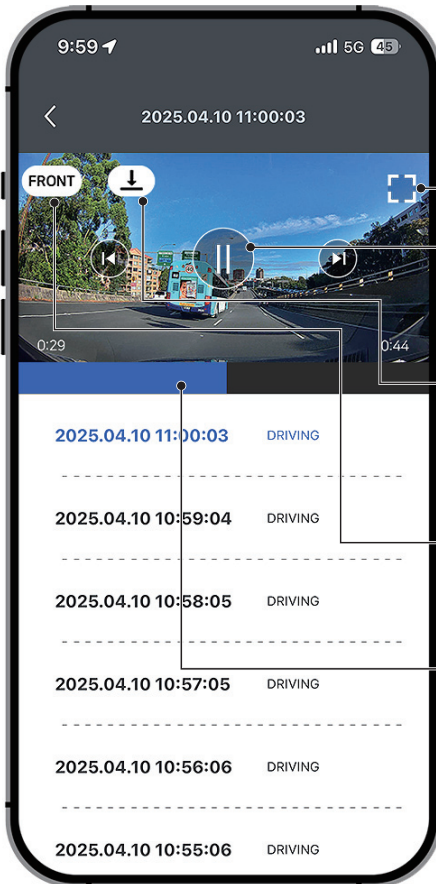

• **6-1. Full screen**

• **6-2. Play icon**

You can stop, play, or skip to the next or previous video in the currently playing video.

• **6-3. Video download**

Downloads the currently playing video. The downloaded video is saved on your smartphone.

• **6-4. Front/Rear Switching**

You can choose either front or rear vide

• **6-5. Playing position**

It marks the position in the currently playing video. You can drag and drop with your finger.

7. Download Video

- Tap the Download icon on the playback screen.
It provides a list of archived videos, which you can play or share.

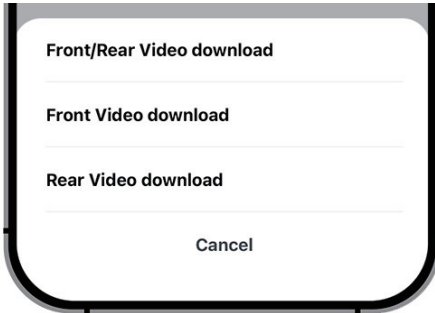

7-1. Front/Rear download

Tap the front camera, rear camera, or all cameras button to download the desired video file.

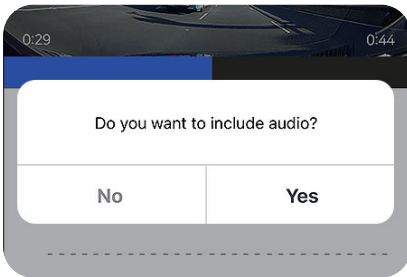

7-2. Download include audio

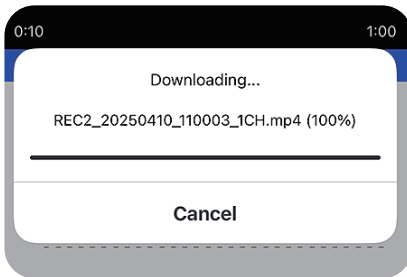

7-3. Download complete

The downloaded video files will be saved in your smartphone gallery or you can also check them in the file list 'storage'.

8. Setting

- Tap the settings button on the main screen.
You can select the menu you want and adjust the settings.

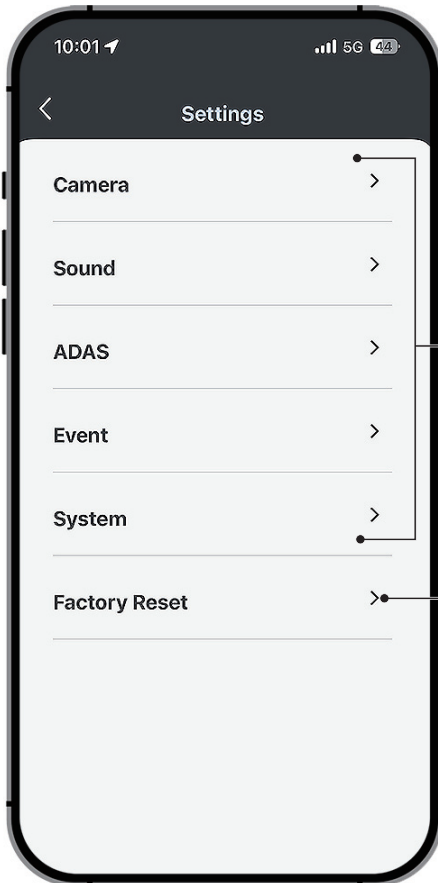

• Dashcam setting

You can adjust the settings for camera, sound, ADAS, event, and system.

• Factory reset

- When you change the dashcam setting, the memory card may be initialized, and a pop-up appears over the app during initialization. Please pay attention to that pop-up.

8-1. Setting - Camera

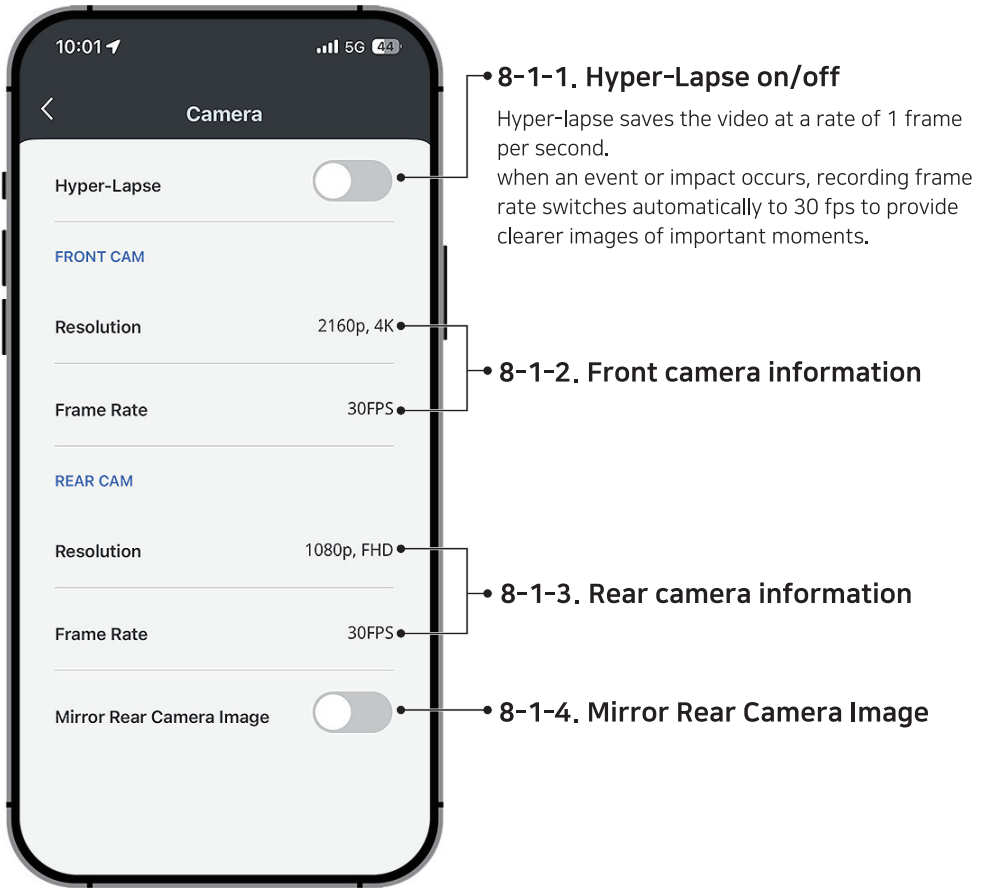

8-2. Setting-Sound

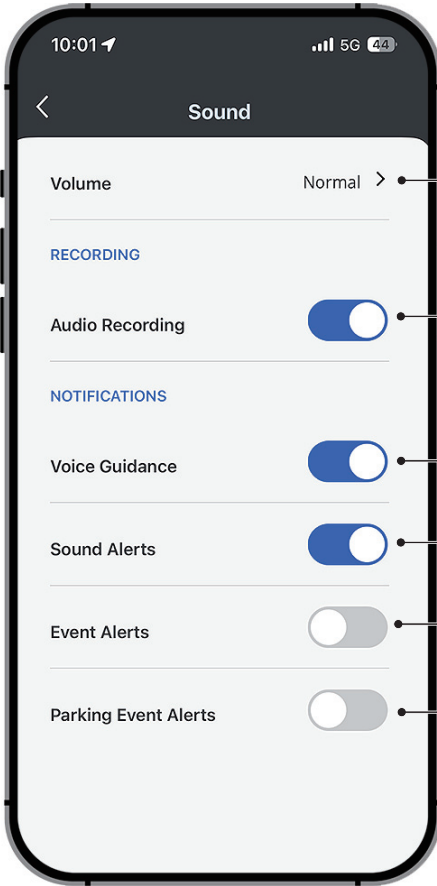

8-2-1. Speaker Volume

You can adjust the speaker volume in three levels 'Low', 'Normal', 'High'.

8-2-2. Audio Recording on/off

8-2-3. Voice Guidance on/off

8-2-4. Sound Alerts on/off

8-2-5. Event Alerts on/off

8-2-6. Parking Event Alerts on/off

8-3. Setting-ADAS

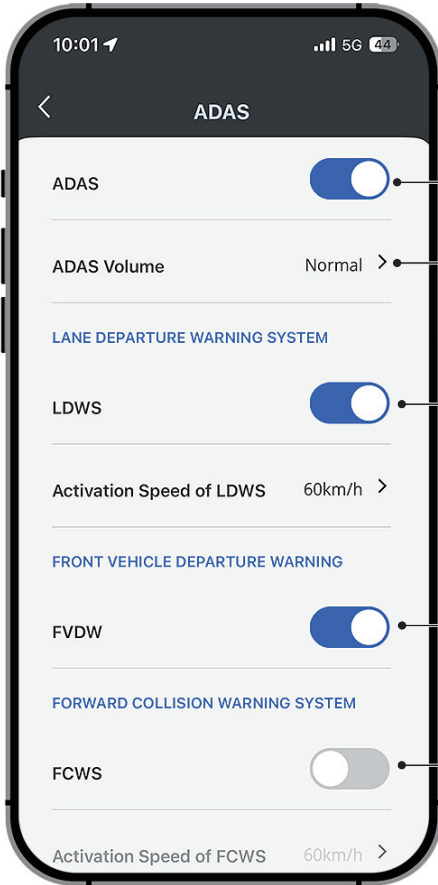

8-3-1. ADAS on/off

8-3-2. ADAS Volume

You can adjust the speaker volume in three levels 'Low', 'Normal', 'High'.

8-3-3. LDWS on/off

Lane Departure Warning System
The activation speed can be set to 60km, 80km, 100km with the default setting set to 60km.

8-3-4. FVDW on/off

Front Vehicle Departure Warning

8-3-5. FCWS on/off

Forward Collision Warning System
The activation speed can be set to 40km, 60km, 80km with the default setting set to 60km.

8-4. Setting-Event

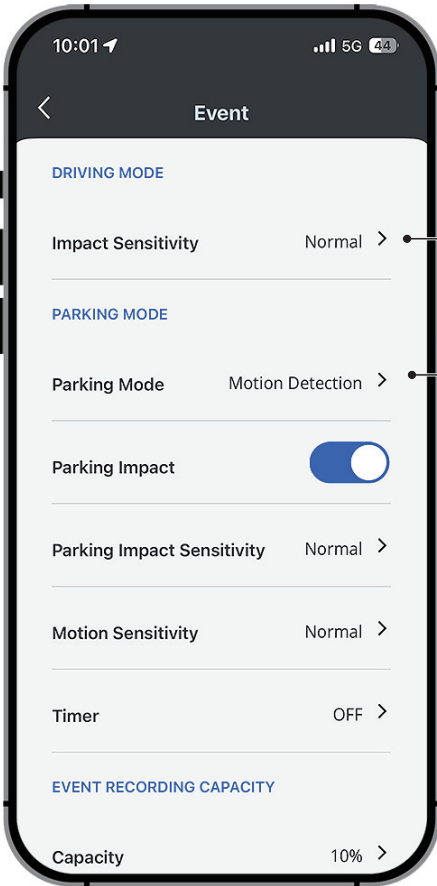

8-4-1. Impact Sensitivity

You can adjust the impact sensitivity (driving mode) in three levels 'Low', 'Normal', 'High'.

8-4-2. Parking Mode

Select a mode :

Time-Lapse, Motion Detection, or Off.

Time-Lapse

Time-lapse saves the video at a rate of 1 frame per second, when an event or impact occurs, recording frame rate switches automatically to 30 fps to provide clearer images of important moments.

Parking mode	Normal	Time-lapse
Capacity	64GB	64GB
Frame	30fps	1fps
Recording time	About 8H	About 96H

Motion Detection

In parking mode, recording will only occur when motion is detected.

8-4. Setting-Event

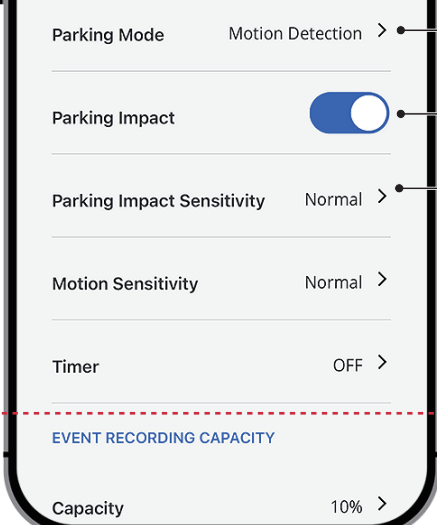

8-4-3. Parking Impact on/off

8-4-4. Parking Impact Sensitivity
You can adjust the impact sensitivity (parking mode) in three levels 'Low', 'Normal', 'High'.

8-4-5. Motion Sensitivity
You can adjust the motion sensitivity (parking mode) in three levels 'Low', 'Normal', 'High'.

8-4-6. Event Recording Capacity
Event data (impacts, motion, etc.) will be allocated within the memory card storage space.

Warning
If this setting is changed, all recorded data will be deleted from the SD card.

The image shows a mobile application settings screen. At the top, there are two sections: 'Parking Mode' and 'Motion Detection', each with a right-pointing chevron. Below these are four settings: 'Parking Impact' with a blue toggle switch, 'Parking Impact Sensitivity' set to 'Normal' with a chevron, 'Motion Sensitivity' set to 'Normal' with a chevron, and 'Timer' set to 'OFF' with a chevron. A red dashed box highlights the bottom section of the screen, which includes a blue header 'EVENT RECORDING CAPACITY' and a 'Capacity' setting at 10% with a chevron. Below this is a detailed view of the 'Event Recording Capacity' setting, showing a progress bar from 10% to a maximum of 90%. A red warning message is displayed at the bottom of this detailed view: 'Warning: If this setting is changed, all recorded data will be deleted from the SD card.'

8-5. Setting-System

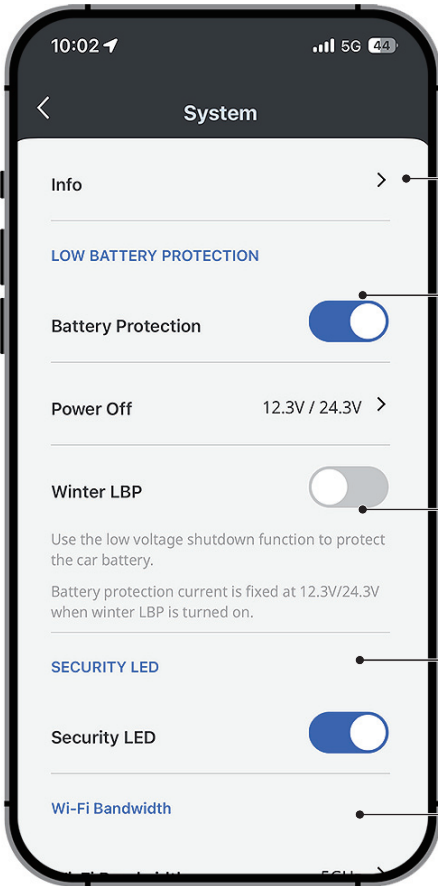

8-5-1. Info

Enter user information and check the dash cam details.

8-5-2. Low Battery Protection

In order to prevent a car battery from discharge during the parking mode, It has parking timer and voltage cut-off setting mode. If the voltage is lower than the set volume, it executes the voltage cut-off automatically for preventing the car discharging.

8-5-3. Security LED

Turn the security LED(front camera) on or off in driving mode or parking mode.

8-6. Firmware Update from App

- DASHCAM connection is required for product recognition.
(Remember the last connected product)

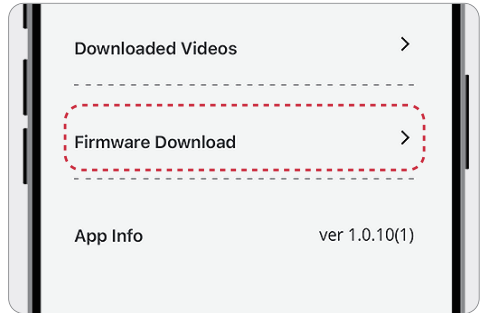
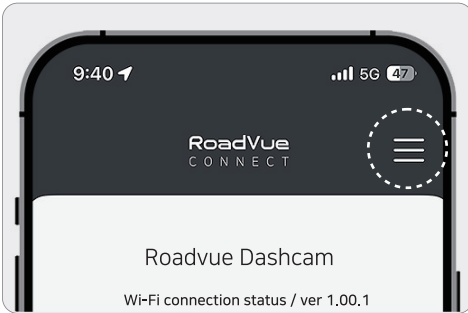

8-6-1. Step 1

Tap the F/W Update button on the main screen. A Firmware Download is displayed.

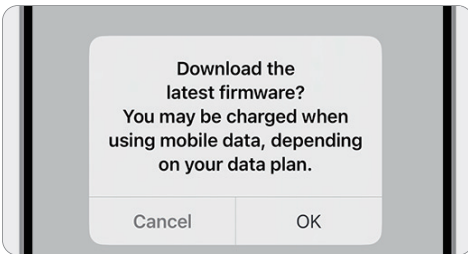

8-6-2. Step 2

Internet access will be restricted after a Wi-Fi connection
Please proceed with firmware download without connecting DASHCAM

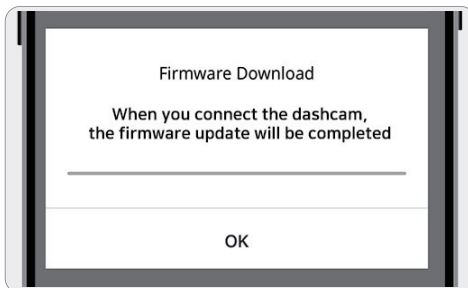

8-6-3. Step 3

When you connect the DASHCAM, the firmware will be updated, and the DASHCAM will be rebooted after completion

1. Using the PC viewer (windows)



1	The main window in which the recorded video is played. (Front/rear video)
2	It allows you to load, play, or stop recorded video.
3	If the recorded video contains GPS information, the driving speed is displayed.
4	The G-Sensor value or driving speed is graphed.
5	It displays a list of recorded videos
6	If the recorded video contains GPS information, the location is displayed on the map.
7	Full-screen (Switch screens front, rear)
8	Dashcam settings save the current video
9	Change language

2. Using the PC viewer (MAC)



1	The main window in which the recorded video is played, (Front/rear video)
2	It allows you to load, play, or stop recorded video.
3	It displays a list of recorded videos
4	The G-Sensor value or driving speed is graphed.
5	If the recorded video contains GPS information, the location is displayed on the map.
6	Full-screen (Switch screens front, rear)
7	Dashcam settings
8	Video download

FCC Compliance Statement

This device complies with part 15 of the FCC rules. Operation is subject to the following two conditions: (1) This device may not cause harmful interference, and (2) this device must accept any interference received, including interference that may cause undesired operation

This equipment has been tested and found to comply with the limits for a Class B digital device, pursuant to part 15 of the FCC Rules. These limits are designed to provide reasonable protection against harmful interference in a residential installation. This equipment generates, uses and can radiate radio frequency energy and, if not installed and used in accordance with the instructions, may cause harmful interference to radio communications. However, there is no guarantee that interference will not occur in a particular installation. If this equipment does cause harmful interference to radio or television reception, which can be determined by turning the equipment off and on, the user is encouraged to correct the interference by one of the following measures:

- Reorient or relocate the receiving antenna.
- Increase the separation between the equipment and receiver.
- Connect the equipment into an outlet on a circuit different from which the receiver is connected.
- Consult the dealer or an experienced radio/TV technician for help.

FCC Caution

Any changes or modifications to the equipment not expressly approved by the party responsible for compliance could void your authority to operate the equipment.

This transmitter must not be co-located or operating in conjunction with any other antenna or transmitter.

FCC Radiation Exposure Statement

This equipment complies with FCC radiation exposure limits set forth for an uncontrolled environment. This equipment should be installed and operated with minimum distance 20 cm between the radiator and your body.



A person's hand is reaching out towards a bright horizon over a road. The scene is very bright and hazy, suggesting a sunrise or sunset. The person's hand is in the foreground, and the road stretches into the distance. The overall tone is light and airy.

RoadVue

A U S T R A L I A

Model : RV9

Product : ROADVUE DASH CAM

www.roadvue.com.au